



# ODKVAPOVÝ SYSTÉM HRANATÝ



**CENNÍK**  
2021



POWERFUL PARTNER FOR YOUR ROOF



Pozinkovaný  
materiál | 3



Žraby | 6



Háky | 8



Dilatácie | 10



Rohy | 12



Čelá | 14



Kotlíky | 15



Kolená | 25



Zvodové  
rúry | 26



Objímky | 29



Objímky  
príslušenstvo | 30



Zachytávače  
vody | 32



Ochranné  
zvodové rúry | 33



Kanalizačné  
vpuste | 36

## ROZMERY STREŠNÝCH ŽLABOV

(rozмеры a rozmerové tolerance podľa EN 612)

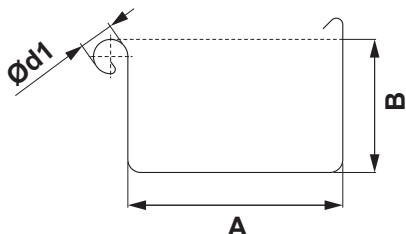

| Rozvinutá šírka (mm) | 200 | 250 | 333 | 400 | 500 |
|----------------------|-----|-----|-----|-----|-----|
| A                    | 70  | 85  | 120 | 150 | 200 |
| B                    | 42  | 55  | 75  | 90  | 110 |
| Ø d1                 | 16  | 18  | 20  | 22  | 22  |

## VNÚTORNÝ FALZ

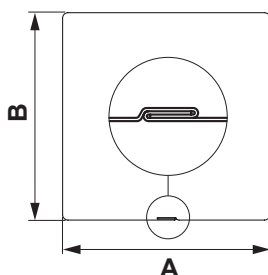

## ROZMERY STREŠNÝCH ZVODOV

(rozмеры a rozmerové tolerance podľa EN 612)

| Rozmery          | 80 x 80 | 100 x 100 | 120 x 120 | 150 x 150 |
|------------------|---------|-----------|-----------|-----------|
| Menovitá veľkosť | 80      | 100       | 120       | 150       |

## ROZMERY STREŠNÝCH HÁKOV

(rozмеры a rozmerové tolerance podľa EN 612)

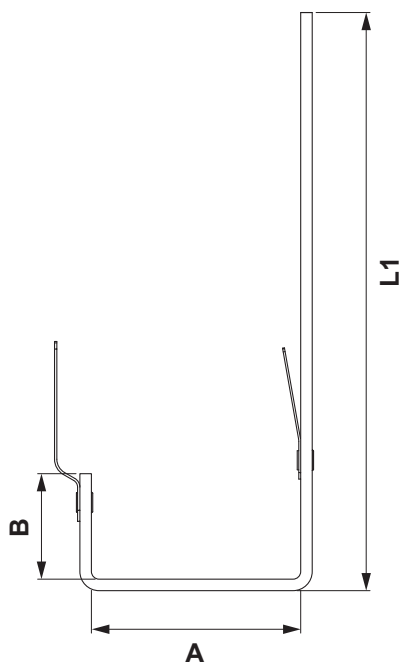

| Rozmery (mm) | L1  | A   | B  |
|--------------|-----|-----|----|
| 200          | 275 | 72  | 28 |
| 250          | 302 | 87  | 38 |
| 333          | 351 | 123 | 55 |
| 400          | 384 | 153 | 68 |
| 500          | 355 | 202 | 88 |

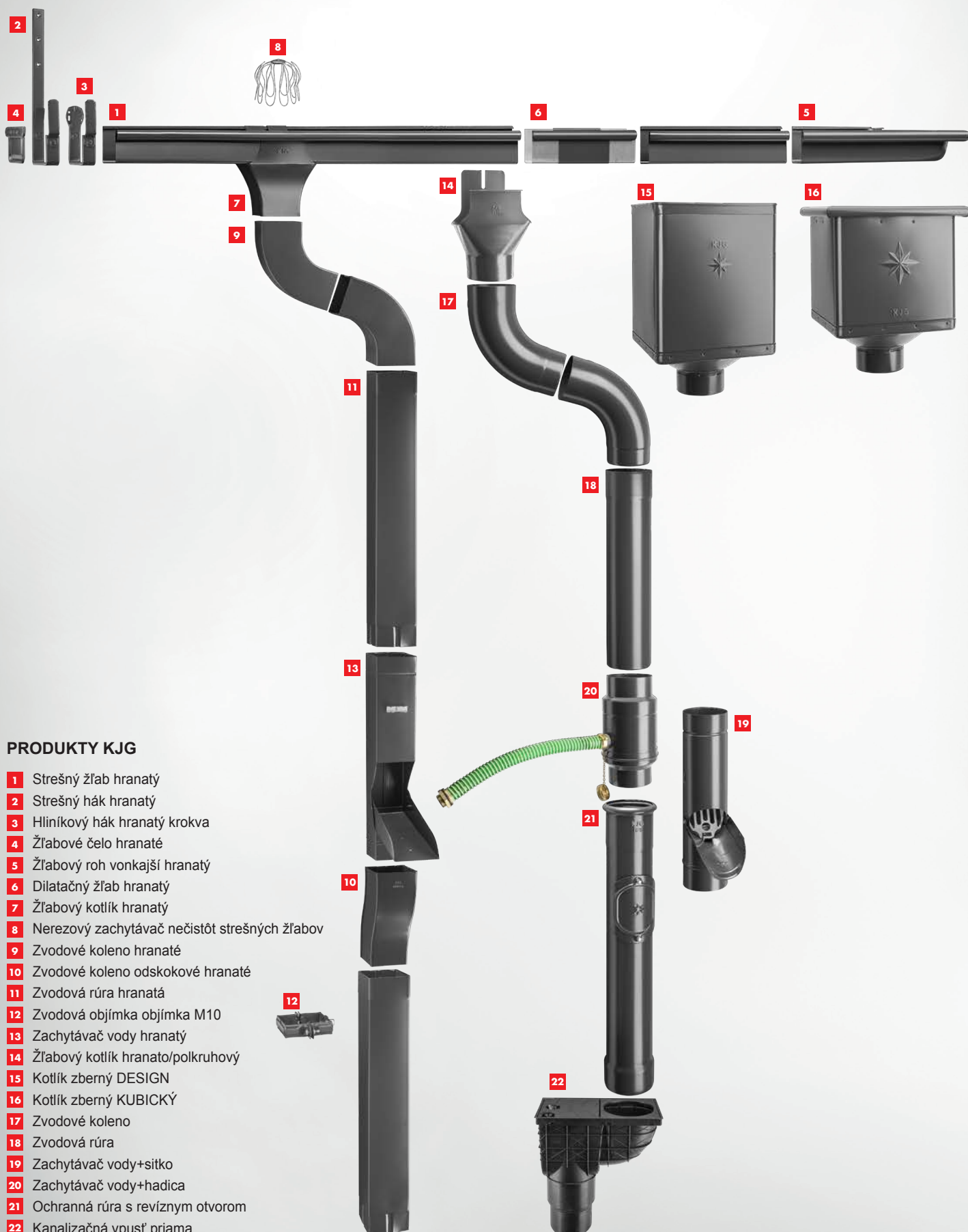

## PRODUKTY KJG

- 1 Strešný žlab hranatý
- 2 Strešný hák hranatý
- 3 Hliníkový hák hranatý krokva
- 4 Žlabové čelo hranaté
- 5 Žlabový roh vonkajší hranatý
- 6 Dilatačný žlab hranatý
- 7 Žlabový kotlík hranatý
- 8 Nerezový zachytávač nečistôt strešných žlabov
- 9 Zvodové koleno hranaté
- 10 Zvodové koleno odskokové hranaté
- 11 Zvodová rúra hranatá
- 12 Zvodová objímka objímka M10
- 13 Zachytávač vody hranatý
- 14 Žlabový kotlík hranato/polokruhový
- 15 Kotlík zberný DESIGN
- 16 Kotlík zberný KUBICKÝ
- 17 Zvodové koleno
- 18 Zvodová rúra
- 19 Zachytávač vody+sitko
- 20 Zachytávač vody+hadica
- 21 Ochranná rúra s revíznym otvorom
- 22 Kanalizačná vpusť priama

## TATA STEEL

Spoločnosť Tata bola založená v roku 1868 spoločnosťou Jamsetji Nusserwanji Tata a sídlom v Indii. Je globálnym obchodným konglomerátom, ktorý pôsobí vo viac ako 100 krajinách na piatich kontinentoch. Od skorého nástupu do ocele a automobilov, aby sa držal krok s najnovšími technológiami, má dnes skupina Tata silnú pozíciu v rôznych odvetviach, ako sú agrochemikálie, automobilový priemysel, chemikálie, stavebníctvo, financie a spotrebné výroby.

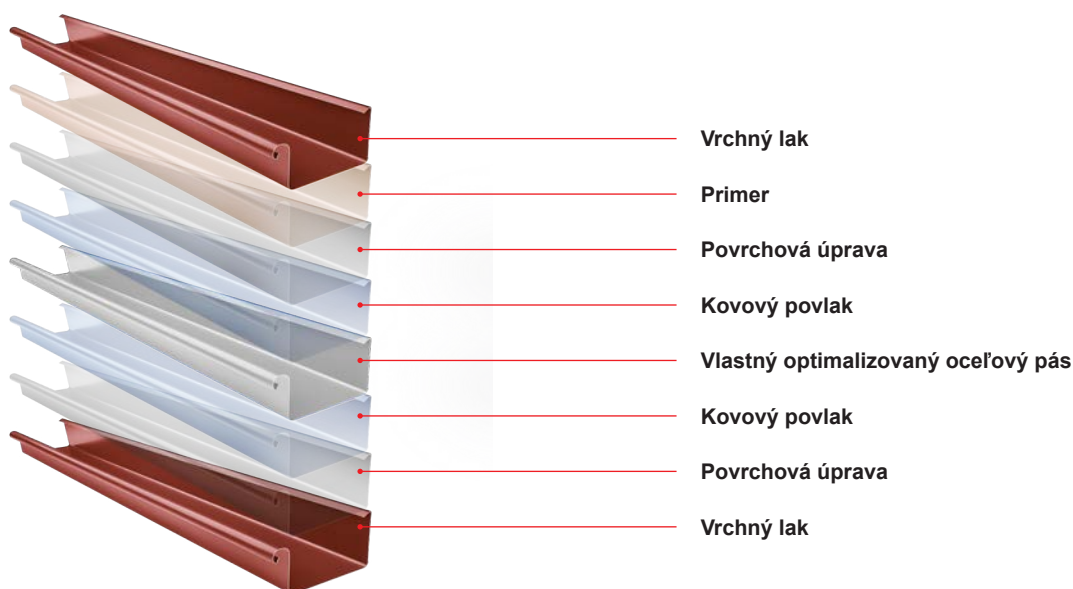

## STREŠNÝ ŽĽAB HRANATÝ [s=0,55]

PH-PZH D

| Menovitá veľkosť   | 200     |          | 250     |          | 250     |        | 333     |          | 333     |          |       |
|--|---------|----------|---------|----------|---------|--------|---------|----------|---------|----------|-------|
|  | 3,0     |          | 4,0     |          | 6,0     |        | 4,0     |          | 6,0     |          |       |
| Dĺžka v m  | 3,0     |          | 4,0     |          | 6,0     |        | 4,0     |          | 6,0     |          |       |
| Cena v €/m   | Bez DPH | S DPH    | Bez DPH | S DPH    | Bez DPH | S DPH  | Bez DPH | S DPH    | Bez DPH | S DPH    |       |
| <b>TM</b><br>Testa di Moro<br>RAL 8028   | 1       | 7,90     | 9,48    | 7,90     | 9,48    |        |         | 8,35     | 10,02   | 8,35     | 10,02 |
|  |         | 017147   |         | 017154   |         |        |         | 017161   |         | 017178   |       |
| <b>AN</b><br>Antracit<br>RAL 7016  | 2       | 7,90     | 9,48    | 7,90     | 9,48    | 7,90   | 9,48    | 8,35     | 10,02   | 8,35     | 10,02 |
|  |         | 016515   |         | 016522   |         | 016539 |         | 016546   |         | 016553   |       |
| <b>IC</b><br>Intenzívna čierna<br>RAL 9005   | 3       | 7,90     | 9,48    | 7,90     | 9,48    |        |         | 8,35     | 10,02   | 8,35     | 10,02 |
|  |         | 016669   |         | 016676   |         |        |         | 016683   |         | 016690   |       |
| <b>OC</b><br>Oceľovo červená<br>RAL 3009   | 4       | 7,90     | 9,48    | 7,90     | 9,48    |        |         | 8,35     | 10,02   | 8,35     | 10,02 |
|  |         | 016959 * |         | 016966   |         |        |         | 016973   |         | 016980   |       |
| <b>MH</b><br>Medeno hnedá<br>RAL 8004  | 5       | 8,10     | 9,72    | 8,10     | 9,72    |        |         | 8,55     | 10,26   | 8,55     | 10,26 |
|  |         | 016737 * |         | 016744   |         |        |         | 016751   |         | 016768   |       |
| <b>SB</b><br>Šedo biela<br>RAL 9002  | 6       | 8,10     | 9,72    | 8,10     | 9,72    |        |         | 8,55     | 10,26   |          |       |
|  |         | 017093   |         | 017109   |         |        |         | 017116   |         |          |       |
| <b>BH</b><br>Bielo hliníková<br>RAL 9006   | 7       | 8,10     | 9,72    | 8,10     | 9,72    |        |         | 8,55     | 10,26   | 8,55     | 10,26 |
|  |         | 016591   |         | 016607   |         |        |         | 016614   |         | 016621   |       |
| <b>PS</b><br>Prachovo šedá<br>RAL 7037   | 8       | 8,10     | 9,72    | 8,10     | 9,72    |        |         | 8,55     | 10,26   | 8,55     | 10,26 |
|  |         | 017024   |         | 017031   |         |        |         | 017048   |         | 017055   |       |
| <b>MM</b><br>Metalická medená<br>RAL extra   | 9       | 8,30     | 9,96    | 8,30     | 9,96    |        |         | 8,75     | 10,50   |          |       |
|  |         | 016805 * |         | 016812 * |         |        |         | 016829 * |         |          |       |
| <b>BHT – P.20</b><br>Bielo hliníková tmavá<br>RAL 9007   | 10      | 8,30     | 9,96    | 8,30     | 9,96    |        |         | 8,75     | 10,50   | 8,75     | 10,50 |
|  |         | 110800 * |         | 096524   |         |        |         | 096531   |         | 096548 * |       |
| <b>MZ</b><br>Machovo zelená<br>RAL 6005  | 11      | 8,30     | 9,96    | 8,30     | 9,96    |        |         | 8,75     | 10,50   |          |       |
|  |         | 016904 * |         | 016911 * |         |        |         | 016928   |         |          |       |
| <b>MOT</b><br>Tmavo modrá<br>RAL 5010  | 12      | 8,30     | 9,96    | 8,30     | 9,96    |        |         | 8,75     | 10,50   |          |       |
|  |         | 016850 * |         | 016867 * |         |        |         | 016874 * |         |          |       |
| <b>TZ</b><br>Trávovo zelená<br>RAL 6011  | 13      |          |         | 8,30     | 9,96    |        |         | 8,75     | 10,50   |          |       |
|  |         |          |         | 017215 * |         |        |         | 017222 * |         |          |       |
| <b>Balenie v m</b>  |         | 6        |         | 8        |         | 12     |         | 8        |         | 12       |       |
| <b>Balenie v m</b>  |         | 300      |         | 400      |         | 600    |         | 224      |         | 336      |       |

\* Výroba na objednávku



## STREŠNÝ ŽLAB HRANATÝ [s=0,55]

PH-PZH

| Menovitá veľkosť  | 400        |              | 400        |              | 500       |              |
|---|------------|--------------|------------|--------------|-----------|--------------|
|   | 4,0        |              | 6,0        |              | 4,0       |              |
| Dĺžka v m   | 4,0        |              | 6,0        |              | 4,0       |              |
| Cena v €/m  | Bez DPH    | S DPH        | Bez DPH    | S DPH        | Bez DPH   | S DPH        |
| <b>TM</b> 1<br>Testa di Moro<br>RAL 8028                  | 12,60      | <b>15,12</b> | 12,60      | <b>15,12</b> | 17,30     | <b>20,76</b> |
|   | 017185     |              | 017192     |              | 017208 *  |              |
| <b>AN</b> 2<br>Antracit<br>RAL 7016                       | 12,60      | <b>15,12</b> | 12,60      | <b>15,12</b> | 17,30     | <b>20,76</b> |
|   | 016560     |              | 016577     |              | 016584    |              |
| <b>IC</b> 3<br>Intenzívna čierna<br>RAL 9005              | 12,60      | <b>15,12</b> | 12,60      | <b>15,12</b> | 17,30     | <b>20,76</b> |
|   | 016706     |              | 016713     |              | 016720 *  |              |
| <b>OC</b> 4<br>Oceľovo červená<br>RAL 3009                | 12,60      | <b>15,12</b> | 12,60      | <b>15,12</b> | 17,30     | <b>20,76</b> |
|   | 016997     |              | 017000 *   |              | 017017 *  |              |
| <b>MH</b> 5<br>Medeno hnedá<br>RAL 8004                   | 12,80      | <b>15,36</b> | 12,80      | <b>15,36</b> | 17,50     | <b>21,00</b> |
|   | 016775     |              | 016782 *   |              | 016799 *  |              |
| <b>SB</b> 6<br>Šedo biela<br>RAL 9002                     | 12,80      | <b>15,36</b> |            |              | 17,50     | <b>21,00</b> |
|   | 017123     |              |            |              | 017130 *  |              |
| <b>BH</b> 7<br>Bielo hliníková<br>RAL 9006                | 12,80      | <b>15,36</b> | 12,80      | <b>15,36</b> | 17,50     | <b>21,00</b> |
|   | 016638     |              | 016645     |              | 016652    |              |
| <b>PS</b> 8<br>Prachovo šedá<br>RAL 7037                  | 12,80      | <b>15,36</b> | 12,80      | <b>15,36</b> | 17,50     | <b>21,00</b> |
|   | 017062     |              | 017079     |              | 017086 *  |              |
| <b>MM</b> 9<br>Metalická medená<br>RAL extra              | 13,00      | <b>15,60</b> |            |              | 17,70     | <b>21,24</b> |
|   | 016836 *   |              |            |              | 016843 *  |              |
| <b>BHT – P.20</b> 10<br>Bielo hliníková tmavá<br>RAL 9007 | 13,00      | <b>15,60</b> | 13,00      | <b>15,60</b> |           |              |
|   | 110824 *   |              | 110817 *   |              |           |              |
| <b>MZ</b> 11<br>Machovo zelená<br>RAL 6005                | 13,00      | <b>15,60</b> |            |              | 17,70     | <b>21,24</b> |
|   | 016935 *   |              |            |              | 016942 *  |              |
| <b>MOT</b> 12<br>Tmavo modrá<br>RAL 5010                  | 13,00      | <b>15,60</b> |            |              | 17,70     | <b>21,24</b> |
|   | 016881 *   |              |            |              | 016898 *  |              |
| <b>TZ</b> 13<br>Trávovo zelená<br>RAL 6011                | 13,00      | <b>15,60</b> |            |              | 17,70     | <b>21,24</b> |
|   | 017239 *   |              |            |              | 017246    |              |
| <b>Balenie v m</b> 📦                                      | <b>8</b>   |              | <b>12</b>  |              | <b>8</b>  |              |
| <b>Balenie v m</b> 🚚                                      | <b>144</b> |              | <b>216</b> |              | <b>80</b> |              |

\* Výroba na objednávku



## STREŠNÝ ŽLABOVÝ HÁK HRANATÝ

PH-PHH

| Menovitá veľkosť  | 200/380  |          | 250/430 |          | 333/550 |          | 400/610 |          | 500/650 |          |      |
|---|----------|----------|---------|----------|---------|----------|---------|----------|---------|----------|------|
|   | Materiál |          | 25/5    |          | 25/6    |          | 25/6    |          | 25/6    |          |      |
| Cena v €/ks   | Bez DPH  | S DPH    | Bez DPH | S DPH    | Bez DPH | S DPH    | Bez DPH | S DPH    | Bez DPH | S DPH    |      |
| <b>TM</b><br>Testa di Moro<br>RAL 8028  | 1        | 3,55     | 4,26    | 3,65     | 4,38    | 4,35     | 5,22    | 7,30     | 8,76    | 7,35     | 8,82 |
|   |          | 018304   |         | 018311   |         | 018328   |         | 018335   |         | 018359 * |      |
| <b>AN</b><br>Antracit<br>RAL 7016   | 2        | 3,55     | 4,26    | 3,65     | 4,38    | 4,35     | 5,22    | 7,30     | 8,76    | 7,35     | 8,82 |
|   |          | 017642   |         | 017659   |         | 017666   |         | 017673   |         | 017697   |      |
| <b>IC</b><br>Intenzívna čierna<br>RAL 9005  | 3        | 3,55     | 4,26    | 3,65     | 4,38    | 4,35     | 5,22    | 7,30     | 8,76    | 7,35     | 8,82 |
|   |          | 017789   |         | 017796   |         | 017802   |         | 017819   |         | 017833 * |      |
| <b>OC</b><br>Oceľovo červená<br>RAL 3009  | 4        | 3,55     | 4,26    | 3,65     | 4,38    | 4,35     | 5,22    | 7,30     | 8,76    | 7,35     | 8,82 |
|   |          | 018090 * |         | 018106   |         | 018113   |         | 018120 * |         | 018144 * |      |
| <b>MH</b><br>Medeno hnedá<br>RAL 8004   | 5        | 3,55     | 4,26    | 3,65     | 4,38    | 4,35     | 5,22    | 7,30     | 8,76    | 7,35     | 8,82 |
|   |          | 017857 * |         | 017864   |         | 017871   |         | 017888 * |         | 017901 * |      |
| <b>SB</b><br>Šedo biela<br>RAL 9002   | 6        | 3,55     | 4,26    | 3,65     | 4,38    | 4,35     | 5,22    | 7,30     | 8,76    | 7,35     | 8,82 |
|   |          | 018236   |         | 018243   |         | 018250   |         | 018267   |         | 018281 * |      |
| <b>BH</b><br>Bielo hliníková<br>RAL 9006  | 7        | 3,55     | 4,26    | 3,65     | 4,38    | 4,35     | 5,22    | 7,30     | 8,76    | 7,35     | 8,82 |
|   |          | 017710   |         | 017727   |         | 017734   |         | 017741   |         | 017765   |      |
| <b>PS</b><br>Prachovo šedá<br>RAL 7037  | 8        | 3,55     | 4,26    | 3,65     | 4,38    | 4,35     | 5,22    | 7,30     | 8,76    | 7,35     | 8,82 |
|   |          | 018168   |         | 018175   |         | 018182   |         | 018199   |         | 018212 * |      |
| <b>MM</b><br>Metalická medená<br>RAL extra  | 9        | 3,55     | 4,26    | 3,65     | 4,38    | 4,35     | 5,22    | 7,30     | 8,76    | 7,35     | 8,82 |
|   |          | 017925 * |         | 017932 * |         | 017949 * |         | 017956 * |         | 017963 * |      |
| <b>BHT – P.20</b><br>Bielo hliníková tmavá<br>RAL 9007  | 10       | 3,55     | 4,26    | 3,65     | 4,38    | 4,35     | 5,22    | 7,30     | 8,76    |          |      |
|   |          | 110725 * |         | 096432   |         | 096449   |         | 110732 * |         |          |      |
| <b>MZ</b><br>Machovo zelená<br>RAL 6005   | 11       | 3,55     | 4,26    | 3,65     | 4,38    | 4,35     | 5,22    | 7,30     | 8,76    | 7,35     | 8,82 |
|   |          | 018021 * |         | 018038 * |         | 018045 * |         | 018052 * |         | 018076 * |      |
| <b>MOT</b><br>Tmavo modrá<br>RAL 5010   | 12       | 3,55     | 4,26    | 3,65     | 4,38    | 4,35     | 5,22    | 7,30     | 8,76    | 7,35     | 8,82 |
|   |          | 017970 * |         | 017987 * |         | 017994 * |         | 018007 * |         | 018014 * |      |
| <b>TZ</b><br>Trávovo zelená<br>RAL 6011   | 13       | 3,55     | 4,26    | 3,65     | 4,38    | 4,35     | 5,22    | 7,30     | 8,76    | 7,35     | 8,82 |
|   |          | 018373 * |         | 018380 * |         | 018397 * |         | 018403 * |         | 018427   |      |
| <b>Balenie v ks</b>  |          | 25       |         | 25       |         | 25       |         | 25       |         | 15       |      |
| <b>Balenie v ks</b>  |          | 1 000    |         | 1 000    |         | 1 000    |         | 1 000    |         | 600      |      |

\* Výroba na objednávku







### HLINÍKOVÝ ŽĽABOVÝ HÁK HRANATÝ KROKVA

### PH-PHHK



| Menovitá veľkosť  | 250      |       | 333      |       | 400      |       |
|---|----------|-------|----------|-------|----------|-------|
|   | 28/7     |       | 28/7     |       | 28/7     |       |
| Materiál  | 28/7     |       | 28/7     |       | 28/7     |       |
| Cena v €/ks   | Bez DPH  | S DPH | Bez DPH  | S DPH | Bez DPH  | S DPH |
| <b>TM</b> 1<br>Testa di Moro<br>RAL 8028  | 4,80     | 5,76  | 4,90     | 5,88  | 7,20     | 8,64  |
|   | 010667   |       | 010674   |       | 010681 * |       |
| <b>AN</b> 2<br>Antracit<br>RAL 7016   | 4,80     | 5,76  | 4,90     | 5,88  | 7,20     | 8,64  |
|   | 010377   |       | 010384   |       | 010391   |       |
| <b>IC</b> 3<br>Intenzívna čierna<br>RAL 9005  | 4,80     | 5,76  | 4,90     | 5,88  | 7,20     | 8,64  |
|   | 010421   |       | 010438   |       | 010445   |       |
| <b>OC</b> 4<br>Oceľovo červená<br>RAL 3009  | 4,80     | 5,76  | 4,90     | 5,88  | 7,20     | 8,64  |
|   | 010575 * |       | 010582 * |       | 010599 * |       |
| <b>MH</b> 5<br>Medeno hnedá<br>RAL 8004   | 4,80     | 5,76  | 4,90     | 5,88  | 7,20     | 8,64  |
|   | 010452 * |       | 010469 * |       | 010476 * |       |
| <b>SB</b> 6<br>Šedo biela<br>RAL 9002   | 4,80     | 5,76  | 4,90     | 5,88  | 7,20     | 8,64  |
|   | 010636   |       | 010643   |       | 010650 * |       |
| <b>BH</b> 7<br>Bielo hliníková<br>RAL 9006  | 4,80     | 5,76  | 4,90     | 5,88  | 7,20     | 8,64  |
|   | 008312   |       | 010407   |       | 010414   |       |
| <b>PS</b> 8<br>Prachovo šedá<br>RAL 7037  | 4,80     | 5,76  | 4,90     | 5,88  | 7,20     | 8,64  |
|   | 010605   |       | 010612   |       | 010629   |       |
| <b>MM</b> 9<br>Metalická medená<br>RAL extra  | 4,80     | 5,76  | 4,90     | 5,88  | 7,20     | 8,64  |
|   | 010483 * |       | 010490 * |       | 010506 * |       |
| <b>BHT – P.20</b> 10<br>Bielo hliníková tmavá<br>RAL 9007   | 4,80     | 5,76  | 4,90     | 5,88  |          |       |
|   | 096456 * |       | 096463 * |       |          |       |
| <b>MZ</b> 11<br>Machovo zelená<br>RAL 6005  | 4,80     | 5,76  | 4,90     | 5,88  | 7,20     | 8,64  |
|   | 010544 * |       | 010551 * |       | 010568 * |       |
| <b>MOT</b> 12<br>Tmavo modrá<br>RAL 5010  | 4,80     | 5,76  | 4,90     | 5,88  | 7,20     | 8,64  |
|   | 010513 * |       | 010520 * |       | 010537 * |       |
| <b>TZ</b> 13<br>Trávovo zelená<br>RAL 6011  | 4,80     | 5,76  | 4,90     | 5,88  | 7,20     | 8,64  |
|   | 010698 * |       | 010704 * |       | 010711 * |       |
| <b>Balenie v ks</b>  | 25       |       | 256      |       | 25       |       |
| <b>Balenie v ks</b>  | 1 000    |       | 1 000    |       | 1 000    |       |

\* Výroba na objednávku

### DILATAČNÝ ŽĽAB HRANATÝ

PH-PZHDI

| Menovitá veľkosť  | 250/260    |              | 333/260    |              | 400/260   |              |
|---|------------|--------------|------------|--------------|-----------|--------------|
|   | Bez DPH    | S DPH        | Bez DPH    | S DPH        | Bez DPH   | S DPH        |
| <b>TM</b> 1<br>Testa di Moro<br>RAL 8028  | 12,50      | <b>15,00</b> | 14,50      | <b>17,40</b> | 17,00     | <b>20,40</b> |
|   | 013477 *   |              | 013484     |              | 013491    |              |
| <b>AN</b> 2<br>Antracit<br>RAL 7016   | 12,50      | <b>15,00</b> | 14,50      | <b>17,40</b> | 17,00     | <b>20,40</b> |
|   | 013170     |              | 013187     |              | 013194    |              |
| <b>IC</b> 3<br>Intenzívna čierna<br>RAL 9005  | 12,50      | <b>15,00</b> | 14,50      | <b>17,40</b> | 17,00     | <b>20,40</b> |
|   | 013231 *   |              | 013248     |              | 013255 *  |              |
| <b>OC</b> 4<br>Oceľovo červená<br>RAL 3009  | 12,50      | <b>15,00</b> | 14,50      | <b>17,40</b> | 17,00     | <b>20,40</b> |
|   | 013385 *   |              | 013392 *   |              | 013408 *  |              |
| <b>MH</b> 5<br>Medeno hnedá<br>RAL 8004   | 12,50      | <b>15,00</b> | 14,50      | <b>17,40</b> | 17,00     | <b>20,40</b> |
|   | 013262 *   |              | 013279 *   |              | 013286 *  |              |
| <b>SB</b> 6<br>Šedo biela<br>RAL 9002   | 12,50      | <b>15,00</b> | 14,50      | <b>17,40</b> | 17,00     | <b>20,40</b> |
|   | 013446 *   |              | 013453 *   |              | 013460 *  |              |
| <b>BH</b> 7<br>Bielo hliníková<br>RAL 9006  | 12,50      | <b>15,00</b> | 14,50      | <b>17,40</b> | 17,00     | <b>20,40</b> |
|   | 013200 *   |              | 013217     |              | 013224    |              |
| <b>PS</b> 8<br>Prachovo šedá<br>RAL 7037  | 12,50      | <b>15,00</b> | 14,50      | <b>17,40</b> | 17,00     | <b>20,40</b> |
|   | 013415 *   |              | 013422     |              | 013439    |              |
| <b>MM</b> 9<br>Metalická medená<br>RAL extra  | 12,50      | <b>15,00</b> | 14,50      | <b>17,40</b> | 17,00     | <b>20,40</b> |
|   | 013293 *   |              | 013309 *   |              | 013316 *  |              |
| <b>BHT – P.20</b> 10<br>Bielo hliníková tmavá<br>RAL 9007   | 12,50      | <b>15,00</b> | 14,50      | <b>17,40</b> | 17,00     | <b>20,40</b> |
|   | 096357 *   |              | 096364 *   |              | 114037 *  |              |
| <b>MZ</b> 11<br>Machovo zelená<br>RAL 6005  | 12,50      | <b>15,00</b> | 14,50      | <b>17,40</b> | 17,00     | <b>20,40</b> |
|   | 013354 *   |              | 013361 *   |              | 013378 *  |              |
| <b>MOT</b> 12<br>Tmavo modrá<br>RAL 5010  | 12,50      | <b>15,00</b> | 14,50      | <b>17,40</b> | 17,00     | <b>20,40</b> |
|   | 013323 *   |              | 013330 *   |              | 013347 *  |              |
| <b>TZ</b> 13<br>Trávovo zelená<br>RAL 6011  | 12,50      | <b>15,00</b> | 14,50      | <b>17,40</b> | 17,00     | <b>20,40</b> |
|   | 013507 *   |              | 013514 *   |              | 013521 *  |              |
| <b>Balenie v ks</b>  | <b>2</b>   |              | <b>2</b>   |              | <b>2</b>  |              |
| <b>Balenie v ks</b>  | <b>240</b> |              | <b>240</b> |              | <b>80</b> |              |

\* Výroba na objednávku

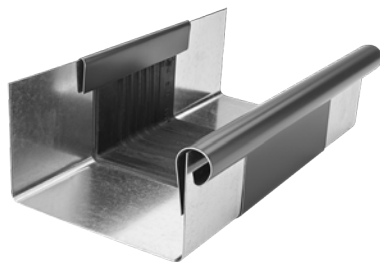

## POUŽITIE DILATAČNÉHO ŽĽABU A DILATAČNÉHO PÁSU

### DILATAČNÝ ŽĽAB

**Príklad montáže: Pododkvapový žľab o rozvinutej šírke do 500 mm.** Dilatačný žľab musí byť namontovaný v rozostupe 15 m. Pre vonkajší roh a začiatok žľabu platí polovica štandardnej hodnoty: maximálne 7,5 m. Pre vnútorný roh platí štvrtina štandardnej hodnoty: maximálne 3,75 m. Pre ostatné materiály a rozmery: pozri tabuľku nižšie. Rohy sa vždy počítajú ako pevné body.

### POLKRUHOVÉ DILATAČNÉ ŽĽABY

| Rozvinutá šírka žľabu | Hliník | Pozink, Titán-zinok, Meď, Nerez |
|-----------------------|--------|---------------------------------|
| < 500                 | 12     | 15                              |
| > 500                 | 8      | 10                              |

### DILATAČNÝ PÁS

**Vnútorňa inštalácia:** na žľaby uchytené bez lepenia na podklad, strechy s neštandardným profilom a oplechovania muriva

### DILATAČNÝ PÁS

| Rozvinutá šírka žľabu | Hliník | Pozink, Titán-zinok, Meď, Nerez |
|-----------------------|--------|---------------------------------|
| < 500                 | 8      | 10                              |
| > 500                 | 6      | 8                               |

Pre vonkajší roh alebo začiatok žľabu platí polovica štandardnej hodnoty. Pre vnútorný roh platí jedna štvrtina štandardnej hodnoty.

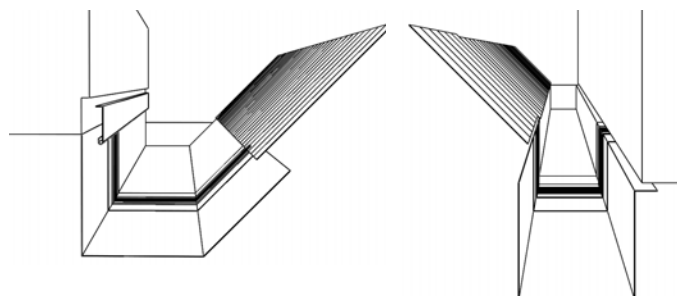
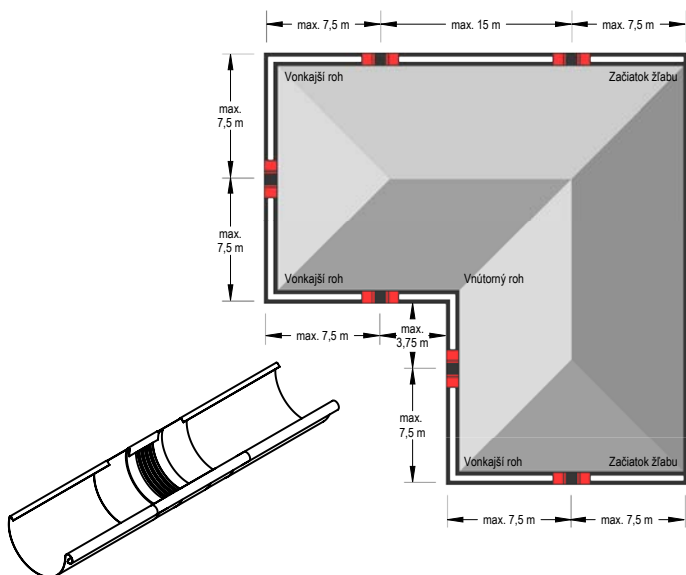

#### Poznámka k montáži dilatačného pásu.

**Pri ohýbaní a montáži dilatačných prvkov sa uistite, že:**



- Ohýbacie čeluste majú rádius minimálne 2 mm.
- Pre hrúbku plechu od 1 mm musí byť dodržaný polomer ohybu minimálne 5 mm.
- Ohýbacie čeluste musia byť pri ohýbaní nastavené na hrúbku strednej gumovej časti 3 až 4 mm, aby sa zabránilo strihaciemu efektu – poškodeniu gumi.
- Gumová stredná časť nesmie byť počas ohýbania stlačená alebo poškodená. Preto by mal byť použitý hliníkový plechový pás 2 až 5 mm (hrubý) ohnutý tak, aby mohol byť pripevnený ako ochrana na ohýbacie čeluste. Tým sa dosiahne väčší polomer ohybu a zabráni sa porušeniu gumovej strednej časti.

#### Poznámka k montáži dilatačného žľabu.

Pri montáži pomocou spájkovania najprv stredný gumový diel prekryte mokrou handričkou (aby nedošlo k prestupu tepla do stredného gumového dielu). Musí sa dodržať minimálna vzdialenosť 6 cm od strednej gumovej časti. V každom prípade sa treba vyhýbať kontaktu gumi s otvoreným plameňom.

### ŽLABOVÝ ROH VONKAJŠÍ HRANATÝ

PH-PRAH



| Menovitá veľkosť  | 200        |              | 250        |              | 333        |              | 400 MAFA  |              | 500 MAFA  |              |
|---|------------|--------------|------------|--------------|------------|--------------|-----------|--------------|-----------|--------------|
|   | Bez DPH    | S DPH        | Bez DPH    | S DPH        | Bez DPH    | S DPH        | Bez DPH   | S DPH        | Bez DPH   | S DPH        |
| <b>TM</b> 1<br>Testa di Moro<br>RAL 8028  | 23,00      | <b>27,60</b> | 22,50      | <b>27,00</b> | 23,90      | <b>28,68</b> | 24,00     | <b>28,80</b> | 27,00     | <b>32,40</b> |
|   | 014443     |              | 014450     |              | 014467     |              | 014474 *  |              | 014481 *  |              |
| <b>AN</b> 2<br>Antracit<br>RAL 7016   | 23,00      | <b>27,60</b> | 22,50      | <b>27,00</b> | 23,90      | <b>28,68</b> | 24,00     | <b>28,80</b> | 27,00     | <b>32,40</b> |
|   | 013958     |              | 013965     |              | 013972     |              | 013989    |              | 013996    |              |
| <b>IC</b> 3<br>Intenzívna čierna<br>RAL 9005  | 23,00      | <b>27,60</b> | 22,50      | <b>27,00</b> | 23,90      | <b>28,68</b> | 24,00     | <b>28,80</b> | 27,00     | <b>32,40</b> |
|   | 014054 *   |              | 014061     |              | 014078     |              | 014085    |              | 014092 *  |              |
| <b>OC</b> 4<br>Oceľovo červená<br>RAL 3009  | 23,00      | <b>27,60</b> | 22,50      | <b>27,00</b> | 23,90      | <b>28,68</b> | 24,00     | <b>28,80</b> | 27,00     | <b>32,40</b> |
|   | 014290 *   |              | 014306     |              | 014313     |              | 014320 *  |              | 014337 *  |              |
| <b>MH</b> 5<br>Medeno hnedá<br>RAL 8004   | 23,00      | <b>27,60</b> | 22,50      | <b>27,00</b> | 23,90      | <b>28,68</b> | 24,00     | <b>28,80</b> | 27,00     | <b>32,40</b> |
|   | 014108 *   |              | 014115     |              | 014122     |              | 014139 *  |              | 014542 *  |              |
| <b>SB</b> 6<br>Šedo biela<br>RAL 9002   | 23,00      | <b>27,60</b> | 22,50      | <b>27,00</b> | 23,90      | <b>28,68</b> | 24,00     | <b>28,80</b> | 27,00     | <b>32,40</b> |
|   | 014399     |              | 014405     |              | 014412     |              | 014429 *  |              | 014436 *  |              |
| <b>BH</b> 7<br>Bielo hliníková<br>RAL 9006  | 23,00      | <b>27,60</b> | 22,50      | <b>27,00</b> | 23,90      | <b>28,68</b> | 24,00     | <b>28,80</b> | 27,00     | <b>32,40</b> |
|   | 014009     |              | 014016     |              | 014023     |              | 014030    |              | 014047    |              |
| <b>PS</b> 8<br>Prachovo šedá<br>RAL 7037  | 23,00      | <b>27,60</b> | 22,50      | <b>27,00</b> | 23,90      | <b>28,68</b> | 24,00     | <b>28,80</b> | 27,00     | <b>32,40</b> |
|   | 014344 *   |              | 014351     |              | 014368     |              | 014375 *  |              | 014382 *  |              |
| <b>MM</b> 9<br>Metalická medená<br>RAL extra  | 23,00      | <b>27,60</b> | 22,50      | <b>27,00</b> | 23,90      | <b>28,68</b> | 24,00     | <b>28,80</b> | 27,00     | <b>32,40</b> |
|   | 014146 *   |              | 014153 *   |              | 014160 *   |              | 014177 *  |              | 014184 *  |              |
| <b>BHT – P.20</b> 10<br>Bielo hliníková tmavá<br>RAL 9007   | 23,00      | <b>27,60</b> | 22,50      | <b>27,00</b> | 23,90      | <b>28,68</b> | 24,00     | <b>28,80</b> |           |              |
|   | 110763 *   |              | 096395     |              | 096401     |              | 110770 *  |              |           |              |
| <b>MZ</b> 11<br>Machovo zelená<br>RAL 6005  | 23,00      | <b>27,60</b> | 22,50      | <b>27,00</b> | 23,90      | <b>28,68</b> | 24,00     | <b>28,80</b> | 27,00     | <b>32,40</b> |
|   | 014245 *   |              | 014252 *   |              | 014269     |              | 014276 *  |              | 014283 *  |              |
| <b>MOT</b> 12<br>Tmavo modrá<br>RAL 5010  | 23,00      | <b>27,60</b> | 22,50      | <b>27,00</b> | 23,90      | <b>28,68</b> | 24,00     | <b>28,80</b> | 27,00     | <b>32,40</b> |
|   | 014191 *   |              | 014207 *   |              | 014214 *   |              | 014221 *  |              | 014238 *  |              |
| <b>TZ</b> 13<br>Trávovo zelená<br>RAL 6011  | 23,00      | <b>27,60</b> | 22,50      | <b>27,00</b> | 23,90      | <b>28,68</b> | 24,00     | <b>28,80</b> | 27,00     | <b>32,40</b> |
|   | 014498 *   |              | 014504 *   |              | 014511 *   |              | 014528 *  |              | 014535 *  |              |
| <b>Balenie v ks</b>  | <b>4</b>   |              | <b>4</b>   |              | <b>4</b>   |              | <b>4</b>  |              | <b>2</b>  |              |
| <b>Balenie v ks</b>  | <b>120</b> |              | <b>120</b> |              | <b>120</b> |              | <b>48</b> |              | <b>24</b> |              |

\* Výroba na objednávku  
**MAFA** – Manufaktúra (ručná výroba)



## ŽLABOVÝ ROH VNÚTORNÝ HRANATÝ

PH-PRIH



| Menovitá veľkosť  | 200 MAFA   |              | 250        |              | 333        |              | 400 MAFA  |              | 500 MAFA  |              |
|---|------------|--------------|------------|--------------|------------|--------------|-----------|--------------|-----------|--------------|
|   | Bez DPH    | S DPH        | Bez DPH    | S DPH        | Bez DPH    | S DPH        | Bez DPH   | S DPH        | Bez DPH   | S DPH        |
| <b>TM</b> 1<br>Testa di Moro<br>RAL 8028  | 23,00      | <b>27,60</b> | 22,50      | <b>27,00</b> | 23,90      | <b>28,68</b> | 24,00     | <b>28,80</b> | 27,00     | <b>32,40</b> |
|   | 015242 *   |              | 015150     |              | 015167     |              | 015174    |              | 015181 *  |              |
| <b>AN</b> 2<br>Antracit<br>RAL 7016   | 23,00      | <b>27,60</b> | 22,50      | <b>27,00</b> | 23,90      | <b>28,68</b> | 24,00     | <b>28,80</b> | 27,00     | <b>32,40</b> |
|   | 014658 *   |              | 014665     |              | 014672     |              | 014689    |              | 014696 *  |              |
| <b>IC</b> 3<br>Intenzívna čierna<br>RAL 9005  | 23,00      | <b>27,60</b> | 22,50      | <b>27,00</b> | 23,90      | <b>28,68</b> | 24,00     | <b>28,80</b> | 27,00     | <b>32,40</b> |
|   | 014757 *   |              | 014764     |              | 014771     |              | 014788    |              | 014795 *  |              |
| <b>OC</b> 4<br>Oceľovo červená<br>RAL 3009  | 23,00      | <b>27,60</b> | 22,50      | <b>27,00</b> | 23,90      | <b>28,68</b> | 24,00     | <b>28,80</b> | 27,00     | <b>32,40</b> |
|   | 015006 *   |              | 015013 *   |              | 015020     |              | 015037 *  |              | 015044 *  |              |
| <b>MH</b> 5<br>Medeno hnedá<br>RAL 8004   | 23,00      | <b>27,60</b> | 22,50      | <b>27,00</b> | 23,90      | <b>28,68</b> | 24,00     | <b>28,80</b> | 27,00     | <b>32,40</b> |
|   | 014801 *   |              | 014818 *   |              | 014825 *   |              | 014832 *  |              | 014849 *  |              |
| <b>SB</b> 6<br>Šedo biela<br>RAL 9002   | 23,00      | <b>27,60</b> | 22,50      | <b>27,00</b> | 23,90      | <b>28,68</b> | 24,00     | <b>28,80</b> | 27,00     | <b>32,40</b> |
|   | 015105 *   |              | 015112     |              | 015129     |              | 015136 *  |              | 015143 *  |              |
| <b>BH</b> 7<br>Bielo hliníková<br>RAL 9006  | 23,00      | <b>27,60</b> | 22,50      | <b>27,00</b> | 23,90      | <b>28,68</b> | 24,00     | <b>28,80</b> | 27,00     | <b>32,40</b> |
|   | 014702 *   |              | 014719     |              | 014726     |              | 014733 *  |              | 014740 *  |              |
| <b>PS</b> 8<br>Prachovo šedá<br>RAL 7037  | 23,00      | <b>27,60</b> | 22,50      | <b>27,00</b> | 23,90      | <b>28,68</b> | 24,00     | <b>28,80</b> | 27,00     | <b>32,40</b> |
|   | 015051 *   |              | 015068     |              | 015075     |              | 015082 *  |              | 015099 *  |              |
| <b>MM</b> 9<br>Metalická medená<br>RAL extra  | 23,00      | <b>27,60</b> | 22,50      | <b>27,00</b> | 23,90      | <b>28,68</b> | 24,00     | <b>28,80</b> | 27,00     | <b>32,40</b> |
|   | 014856 *   |              | 014863 *   |              | 014870 *   |              | 014887 *  |              | 014894 *  |              |
| <b>BHT – P.20</b> 10<br>Bielo hliníková tmavá<br>RAL 9007   | 23,00      | <b>27,60</b> | 22,50      | <b>27,00</b> | 23,90      | <b>28,68</b> | 24,00     | <b>28,80</b> |           |              |
|   | 110787 *   |              | 096418 *   |              | 096425 *   |              | 110794 *  |              |           |              |
| <b>MZ</b> 11<br>Machovo zelená<br>RAL 6005  | 23,00      | <b>27,60</b> | 22,50      | <b>27,00</b> | 23,90      | <b>28,68</b> | 24,00     | <b>28,80</b> | 27,00     | <b>32,40</b> |
|   | 014955 *   |              | 014962 *   |              | 014979     |              | 014986 *  |              | 014993 *  |              |
| <b>MOT</b> 12<br>Tmavo modrá<br>RAL 5010  | 23,00      | <b>27,60</b> | 22,50      | <b>27,00</b> | 23,90      | <b>28,68</b> | 24,00     | <b>28,80</b> | 27,00     | <b>32,40</b> |
|   | 014900 *   |              | 014917 *   |              | 014924 *   |              | 014931 *  |              | 014948 *  |              |
| <b>TZ</b> 13<br>Trávovo zelená<br>RAL 6011  | 23,00      | <b>27,60</b> | 22,50      | <b>27,00</b> | 23,90      | <b>28,68</b> | 24,00     | <b>28,80</b> | 27,00     | <b>32,40</b> |
|   | 015198 *   |              | 015204 *   |              | 015211 *   |              | 015228 *  |              | 015235 *  |              |
| <b>Balenie v ks</b>  | <b>4</b>   |              | <b>4</b>   |              | <b>4</b>   |              | <b>4</b>  |              | <b>2</b>  |              |
| <b>Balenie v ks</b>  | <b>120</b> |              | <b>120</b> |              | <b>120</b> |              | <b>48</b> |              | <b>24</b> |              |

\* Výroba na objednávku  
MAFA – Manufaktúra (ručná výroba)



## ŽLABOVÉ ČELO HRANATÉ

PH-PCLH

| Menovitá veľkosť  | 200          |             | 250          |             | 333          |             | 400         |             | 500         |             |
|---|--------------|-------------|--------------|-------------|--------------|-------------|-------------|-------------|-------------|-------------|
|   | Bez DPH      | S DPH       | Bez DPH      | S DPH       | Bez DPH      | S DPH       | Bez DPH     | S DPH       | Bez DPH     | S DPH       |
| <b>TM</b> 1<br>Testa di Moro<br>RAL 8028  | 1,70         | <b>2,04</b> | 1,65         | <b>1,98</b> | 2,00         | <b>2,40</b> | 2,55        | <b>3,06</b> | 2,90        | <b>3,48</b> |
|   | 005106       |             | 005113       |             | 005120       |             | 005137      |             | 005144 *    |             |
| <b>AN</b> 2<br>Antracit<br>RAL 7016   | 1,70         | <b>2,04</b> | 1,65         | <b>1,98</b> | 2,00         | <b>2,40</b> | 2,55        | <b>3,06</b> | 2,90        | <b>3,48</b> |
|   | 004604       |             | 004611       |             | 004628       |             | 004635      |             | 004642      |             |
| <b>IC</b> 3<br>Intenzívna čierna<br>RAL 9005  | 1,70         | <b>2,04</b> | 1,65         | <b>1,98</b> | 2,00         | <b>2,40</b> | 2,55        | <b>3,06</b> | 2,90        | <b>3,48</b> |
|   | 004703       |             | 004710       |             | 004727       |             | 004734      |             | 004741 *    |             |
| <b>OC</b> 4<br>Oceľovo červená<br>RAL 3009  | 1,70         | <b>2,04</b> | 1,65         | <b>1,98</b> | 2,00         | <b>2,40</b> | 2,55        | <b>3,06</b> | 2,90        | <b>3,48</b> |
|   | 004956 *     |             | 004963       |             | 004970       |             | 004987 *    |             | 004994 *    |             |
| <b>MH</b> 5<br>Medeno hnedá<br>RAL 8004   | 1,70         | <b>2,04</b> | 1,65         | <b>1,98</b> | 2,00         | <b>2,40</b> | 2,55        | <b>3,06</b> | 2,90        | <b>3,48</b> |
|   | 004758 *     |             | 004765 *     |             | 004772 *     |             | 004789 *    |             | 004796 *    |             |
| <b>SB</b> 6<br>Šedo biela<br>RAL 9002   | 1,70         | <b>2,04</b> | 1,65         | <b>1,98</b> | 2,00         | <b>2,40</b> | 2,55        | <b>3,06</b> | 2,90        | <b>3,48</b> |
|   | 005052       |             | 005069       |             | 005076       |             | 005083      |             | 005090 *    |             |
| <b>BH</b> 7<br>Bielo hliníková<br>RAL 9006  | 1,70         | <b>2,04</b> | 1,65         | <b>1,98</b> | 2,00         | <b>2,40</b> | 2,55        | <b>3,06</b> | 2,90        | <b>3,48</b> |
|   | 004659       |             | 004666       |             | 004673       |             | 004680      |             | 004697      |             |
| <b>PS</b> 8<br>Prachovo šedá<br>RAL 7037  | 1,70         | <b>2,04</b> | 1,65         | <b>1,98</b> | 2,00         | <b>2,40</b> | 2,55        | <b>3,06</b> | 2,90        | <b>3,48</b> |
|   | 005007       |             | 005014       |             | 005021       |             | 005038      |             | 005045 *    |             |
| <b>MM</b> 9<br>Metalická medená<br>RAL extra  | 1,70         | <b>2,04</b> | 1,65         | <b>1,98</b> | 2,00         | <b>2,40</b> | 2,55        | <b>3,06</b> | 2,90        | <b>3,48</b> |
|   | 004802 *     |             | 004819 *     |             | 004826 *     |             | 004833 *    |             | 004840 *    |             |
| <b>BHT – P.20</b> 10<br>Bielo hliníková tmavá<br>RAL 9007   | 1,70         | <b>2,04</b> | 1,65         | <b>1,98</b> | 2,00         | <b>2,40</b> | 2,55        | <b>3,06</b> |             |             |
|   | 110701 *     |             | 096371       |             | 096388       |             | 110718 *    |             |             |             |
| <b>MZ</b> 11<br>Machovo zelená<br>RAL 6005  | 1,70         | <b>2,04</b> | 1,65         | <b>1,98</b> | 2,00         | <b>2,40</b> | 2,55        | <b>3,06</b> | 2,90        | <b>3,48</b> |
|   | 004901 *     |             | 004918 *     |             | 004925 *     |             | 004932 *    |             | 004949 *    |             |
| <b>MOT</b> 12<br>Tmavo modrá<br>RAL 5010  | 1,70         | <b>2,04</b> | 1,65         | <b>1,98</b> | 2,00         | <b>2,40</b> | 2,55        | <b>3,06</b> | 2,90        | <b>3,48</b> |
|   | 004857 *     |             | 004864 *     |             | 004871 *     |             | 004888 *    |             | 004895 *    |             |
| <b>TZ</b> 13<br>Trávovo zelená<br>RAL 6011  | 1,70         | <b>2,04</b> | 1,65         | <b>1,98</b> | 2,00         | <b>2,40</b> | 2,55        | <b>3,06</b> | 2,90        | <b>3,48</b> |
|   | 005151 *     |             | 005168 *     |             | 005175 *     |             | 005182 *    |             | 005199 *    |             |
| <b>Balenie v ks</b>  | <b>6/60</b>  |             | <b>6/60</b>  |             | <b>6/60</b>  |             | <b>4/40</b> |             | <b>2/20</b> |             |
| <b>Balenie v ks</b>  | <b>1 440</b> |             | <b>1 440</b> |             | <b>1 440</b> |             | <b>960</b>  |             | <b>480</b>  |             |

\* Výroba na objednávku



## ŽLABOVÝ KOTLÍK HRANATÝ

PH-PKLH

| Menovitá veľkosť  | 250-80/80 MAFA |              | 333-80/80 MAFA |              | 333-100/100 MAFA |              |
|---|----------------|--------------|----------------|--------------|------------------|--------------|
|   | Bez DPH        | S DPH        | Bez DPH        | S DPH        | Bez DPH          | S DPH        |
| <b>TM</b> 1<br>Testa di Moro<br>RAL 8028  | 24,90          | <b>29,88</b> | 25,50          | <b>30,60</b> | 27,00            | <b>32,40</b> |
|   | 009494         |              | 009500         |              | 009517           |              |
| <b>AN</b> 2<br>Antracit<br>RAL 7016   | 24,90          | <b>29,88</b> | 25,50          | <b>30,60</b> | 27,00            | <b>32,40</b> |
|   | 008893         |              | 008909         |              | 008916           |              |
| <b>IC</b> 3<br>Intenzívna čierna<br>RAL 9005  | 24,90          | <b>29,88</b> | 25,50          | <b>30,60</b> | 27,00            | <b>32,40</b> |
|   | 009012         |              | 009029         |              | 009036           |              |
| <b>OC</b> 4<br>Oceľovo červená<br>RAL 3009  | 24,90          | <b>29,88</b> | 25,50          | <b>30,60</b> | 27,00            | <b>32,40</b> |
|   | 009319         |              | 009326 *       |              | 009333           |              |
| <b>MH</b> 5<br>Medeno hnedá<br>RAL 8004   | 24,90          | <b>29,88</b> | 25,50          | <b>30,60</b> | 27,00            | <b>32,40</b> |
|   | 009074 *       |              | 009081 *       |              | 009098           |              |
| <b>SB</b> 6<br>Šedo biela<br>RAL 9002   | 24,90          | <b>29,88</b> | 25,50          | <b>30,60</b> | 27,00            | <b>32,40</b> |
|   | 009432         |              | 009449 *       |              | 009456           |              |
| <b>BH</b> 7<br>Bielo hliníková<br>RAL 9006  | 24,90          | <b>29,88</b> | 25,50          | <b>30,60</b> | 27,00            | <b>32,40</b> |
|   | 008954         |              | 008961 *       |              | 008978           |              |
| <b>PS</b> 8<br>Prachovo šedá<br>RAL 7037  | 24,90          | <b>29,88</b> | 25,50          | <b>30,60</b> | 27,00            | <b>32,40</b> |
|   | 009371         |              | 009388 *       |              | 009395           |              |
| <b>MM</b> 9<br>Metalická medená<br>RAL extra  | 24,90          | <b>29,88</b> | 25,50          | <b>30,60</b> | 27,00            | <b>32,40</b> |
|   | 009135 *       |              | 009142 *       |              | 009159 *         |              |
| <b>BHT – P.20</b> 10<br>Bielo hliníková tmavá<br>RAL 9007   |                |              |                |              |                  |              |
| <b>MZ</b> 11<br>Machovo zelená<br>RAL 6005  | 24,90          | <b>29,88</b> | 25,50          | <b>30,60</b> | 27,00            | <b>32,40</b> |
|   | 009258 *       |              | 009265 *       |              | 009272           |              |
| <b>MOT</b> 12<br>Tmavo modrá<br>RAL 5010  | 24,90          | <b>29,88</b> | 25,50          | <b>30,60</b> | 27,00            | <b>32,40</b> |
|   | 009197 *       |              | 009203 *       |              | 009210 *         |              |
| <b>TZ</b> 13<br>Trávovo zelená<br>RAL 6011  | 24,90          | <b>29,88</b> | 25,50          | <b>30,60</b> | 27,00            | <b>32,40</b> |
|   | 009555 *       |              | 009562 *       |              | 009579 *         |              |
| <b>Balenie v ks</b>  |                | <b>10</b>    |                | <b>8</b>     |                  | <b>8</b>     |
| <b>Balenie v ks</b>  |                | <b>300</b>   |                | <b>240</b>   |                  | <b>240</b>   |

\* Výroba na objednávku  
MAFA – Manufaktúra (ručná výroba)



## ŽLABOVÝ KOTLÍK HRANATÝ

PH-PKLH

| Menovitá veľkosť  | 400-100/100 MAFA |              | 400-120/120 MAFA |              | 500-150/150 MAFA |              |
|---|------------------|--------------|------------------|--------------|------------------|--------------|
|   | Bez DPH          | S DPH        | Bez DPH          | S DPH        | Bez DPH          | S DPH        |
| <b>TM</b> 1<br>Testa di Moro<br>RAL 8028  | 30,00            | <b>36,00</b> | 29,90            | <b>35,88</b> | 35,20            | <b>42,24</b> |
|   | 009524 *         |              | 009531           |              | 009548 *         |              |
| <b>AN</b> 2<br>Antracit<br>RAL 7016   | 30,00            | <b>36,00</b> | 29,90            | <b>35,88</b> | 35,20            | <b>42,24</b> |
|   | 008923           |              | 008930           |              | 008947           |              |
| <b>IC</b> 3<br>Intenzívna čierna<br>RAL 9005  | 30,00            | <b>36,00</b> | 29,90            | <b>35,88</b> | 35,20            | <b>42,24</b> |
|   | 009043           |              | 009050           |              | 009067 *         |              |
| <b>OC</b> 4<br>Oceľovo červená<br>RAL 3009  | 30,00            | <b>36,00</b> | 29,90            | <b>35,88</b> | 35,20            | <b>42,24</b> |
|   | 009340 *         |              | 009357 *         |              | 009364 *         |              |
| <b>MH</b> 5<br>Medeno hnedá<br>RAL 8004   | 30,00            | <b>36,00</b> | 29,90            | <b>35,88</b> | 35,20            | <b>42,24</b> |
|   | 009104 *         |              | 009111 *         |              | 009128 *         |              |
| <b>SB</b> 6<br>Šedo biela<br>RAL 9002   | 30,00            | <b>36,00</b> | 29,90            | <b>35,88</b> | 35,20            | <b>42,24</b> |
|   | 009463 *         |              | 009470           |              | 009487 *         |              |
| <b>BH</b> 7<br>Bielo hliníková<br>RAL 9006  | 30,00            | <b>36,00</b> | 29,90            | <b>35,88</b> | 35,20            | <b>42,24</b> |
|   | 008985 *         |              | 008992           |              | 009005           |              |
| <b>PS</b> 8<br>Prachovo šedá<br>RAL 7037  | 30,00            | <b>36,00</b> | 29,90            | <b>35,88</b> | 35,20            | <b>42,24</b> |
|   | 009401 *         |              | 009418           |              | 009425 *         |              |
| <b>MM</b> 9<br>Metalická medená<br>RAL extra  | 30,00            | <b>36,00</b> | 29,90            | <b>35,88</b> | 35,20            | <b>42,24</b> |
|   | 009166 *         |              | 009173 *         |              | 009180 *         |              |
| <b>BHT – P.20</b> 10<br>Bielo hliníková tmavá<br>RAL 9007   |                  |              |                  |              |                  |              |
| <b>MZ</b> 11<br>Machovo zelená<br>RAL 6005  | 30,00            | <b>36,00</b> | 29,90            | <b>35,88</b> | 35,20            | <b>42,24</b> |
|   | 009289 *         |              | 009296 *         |              | 009302 *         |              |
| <b>MOT</b> 12<br>Tmavo modrá<br>RAL 5010  | 30,00            | <b>36,00</b> | 29,90            | <b>35,88</b> | 35,20            | <b>42,24</b> |
|   | 009227 *         |              | 009234 *         |              | 009241 *         |              |
| <b>TZ</b> 13<br>Trávovo zelená<br>RAL 6011  | 30,00            | <b>36,00</b> | 29,90            | <b>35,88</b> | 35,20            | <b>42,24</b> |
|   | 009586 *         |              | 009593 *         |              | 009609 *         |              |
| <b>Balenie v ks</b>  |                  | <b>10</b>    |                  | <b>10</b>    |                  | <b>2</b>     |
| <b>Balenie v ks</b>  |                  | <b>200</b>   |                  | <b>200</b>   |                  | <b>–</b>     |

\* Výroba na objednávku  
MAFA – Manufaktúra (ručná výroba)







## ŽLABOVÝ KOTLÍK HRANATÝ/POLKRUHOVÝ

PH-PKLG





| Menovitá veľkosť  | 200/60     |              | 250/80     |              | 333/100    |              | 400/120    |              |
|---|------------|--------------|------------|--------------|------------|--------------|------------|--------------|
|   | Bez DPH    | S DPH        | Bez DPH    | S DPH        | Bez DPH    | S DPH        | Bez DPH    | S DPH        |
| <b>TM</b> 1<br>Testa di Moro<br>RAL 8028  | 16,00      | <b>19,20</b> | 15,00      | <b>18,00</b> | 19,90      | <b>23,88</b> | 29,00      | <b>34,80</b> |
|   | 005601     |              | 005618     |              | 005625     |              | 005632     |              |
| <b>AN</b> 2<br>Antracit<br>RAL 7016   | 16,00      | <b>19,20</b> | 15,00      | <b>18,00</b> | 19,90      | <b>23,88</b> | 29,00      | <b>34,80</b> |
|   | 005205     |              | 005212     |              | 005229     |              | 005236     |              |
| <b>IC</b> 3<br>Intenzívna čierna<br>RAL 9005  | 16,00      | <b>19,20</b> | 15,00      | <b>18,00</b> | 19,90      | <b>23,88</b> | 29,00      | <b>34,80</b> |
|   | 005281     |              | 005298     |              | 005304     |              | 005311     |              |
| <b>OC</b> 4<br>Oceľovo červená<br>RAL 3009  | 16,00      | <b>19,20</b> | 15,00      | <b>18,00</b> | 19,90      | <b>23,88</b> | 29,00      | <b>34,80</b> |
|   | 005489 *   |              | 005496     |              | 005502     |              | 005519 *   |              |
| <b>MH</b> 5<br>Medeno hnedá<br>RAL 8004   | 16,00      | <b>19,20</b> | 15,00      | <b>18,00</b> | 19,90      | <b>23,88</b> | 29,00      | <b>34,80</b> |
|   | 005328 *   |              | 005335     |              | 005342     |              | 005359 *   |              |
| <b>SB</b> 6<br>Šedo biela<br>RAL 9002   | 16,00      | <b>19,20</b> | 15,00      | <b>18,00</b> | 19,90      | <b>23,88</b> | 29,00      | <b>34,80</b> |
|   | 005564     |              | 005571     |              | 005588     |              | 005595     |              |
| <b>BH</b> 7<br>Bielo hliníková<br>RAL 9006  | 16,00      | <b>19,20</b> | 15,00      | <b>18,00</b> | 19,90      | <b>23,88</b> | 29,00      | <b>34,80</b> |
|   | 005243     |              | 005250     |              | 005267     |              | 005274     |              |
| <b>PS</b> 8<br>Prachovo šedá<br>RAL 7037  | 16,00      | <b>19,20</b> | 15,00      | <b>18,00</b> | 19,90      | <b>23,88</b> | 29,00      | <b>34,80</b> |
|   | 005526     |              | 005533     |              | 005540     |              | 005557 *   |              |
| <b>MM</b> 9<br>Metalická medená<br>RAL extra  | 16,00      | <b>19,20</b> | 15,00      | <b>18,00</b> | 19,90      | <b>23,88</b> | 29,00      | <b>34,80</b> |
|   | 005366 *   |              | 005373 *   |              | 005380 *   |              | 005397 *   |              |
| <b>BHT – P.20</b> 10<br>Bielo hliníková tmavá<br>RAL 9007   | 16,00      | <b>19,20</b> | 15,00      | <b>18,00</b> | 19,90      | <b>23,88</b> | 29,00      | <b>34,80</b> |
|   | 110749 *   |              | 096470     |              | 096487     |              | 110756 *   |              |
| <b>MZ</b> 11<br>Machovo zelená<br>RAL 6005  | 16,00      | <b>19,20</b> | 15,00      | <b>18,00</b> | 19,90      | <b>23,88</b> | 29,00      | <b>34,80</b> |
|   | 005441 *   |              | 005458 *   |              | 005465 *   |              | 005472 *   |              |
| <b>MOT</b> 12<br>Tmavo modrá<br>RAL 5010  | 16,00      | <b>19,20</b> | 15,00      | <b>18,00</b> | 19,90      | <b>23,88</b> | 29,00      | <b>34,80</b> |
|   | 005403 *   |              | 005410 *   |              | 005427 *   |              | 005434 *   |              |
| <b>TZ</b> 13<br>Trávovo zelená<br>RAL 6011  | 16,00      | <b>19,20</b> | 15,00      | <b>18,00</b> | 19,90      | <b>23,88</b> | 29,00      | <b>34,80</b> |
|   | 005649 *   |              | 005656 *   |              | 005663 *   |              | 005670 *   |              |
| <b>Balenie v ks</b>  | <b>20</b>  |              | <b>20</b>  |              | <b>20</b>  |              | <b>15</b>  |              |
| <b>Balenie v ks</b>  | <b>600</b> |              | <b>600</b> |              | <b>600</b> |              | <b>300</b> |              |

\* Výroba na objednávku

**NEREZOVÝ ZACHYTÁVAČ NEČISTÔT STREŠNÝCH ŽLABOV**

**N-NZN**



| Menovitá veľkosť | EAN číslo výrobku | Balenie v ks  |   | Cena [€/ks] |              |
|------------------|-------------------|---|---|-------------|--------------|
|                  |                   |  |  | Bez DPH     | S DPH        |
| <b>60</b>        | 001153            | 30  | 2 160   | 5,55        | <b>6,66</b>  |
| <b>80</b>        | 001160            | 20  | 1 440   | 5,60        | <b>6,72</b>  |
| <b>100</b>       | 001177            | 15  | 1 080   | 5,70        | <b>6,84</b>  |
| <b>120</b>       | 001184            | 10  | 720   | 6,20        | <b>7,44</b>  |
| <b>150</b>       | 001191            | 5   | 360   | 9,80        | <b>11,76</b> |



### KOTLÍK ZBERNÝ DESIGN

### P-PKLZ DE



| Menovitá veľkosť  | 80        |              | 100       |              | 120       |              |
|---|-----------|--------------|-----------|--------------|-----------|--------------|
|   | Bez DPH   | S DPH        | Bez DPH   | S DPH        | Bez DPH   | S DPH        |
| <b>TM</b> 1<br>Testa di Moro<br>RAL 8028  | 58,00     | <b>69,60</b> | 58,00     | <b>69,60</b> | 64,00     | <b>76,80</b> |
|   | 027702    |              | 027726    |              | 027740    |              |
| <b>AN</b> 2<br>Antracit<br>RAL 7016   | 58,00     | <b>69,60</b> | 58,00     | <b>69,60</b> | 64,00     | <b>76,80</b> |
|   | 026200    |              | 026224    |              | 026248    |              |
| <b>IC</b> 3<br>Intenzívna čierna<br>RAL 9005  | 58,00     | <b>69,60</b> | 58,00     | <b>69,60</b> | 64,00     | <b>76,80</b> |
|   | 026507    |              | 026521    |              | 026545    |              |
| <b>OC</b> 4<br>Oceľovo červená<br>RAL 3009  | 58,00     | <b>69,60</b> | 58,00     | <b>69,60</b> | 64,00     | <b>76,80</b> |
|   | 027252 *  |              | 027276    |              | 027290    |              |
| <b>MH</b> 5<br>Medeno hnedá<br>RAL 8004   | 58,00     | <b>69,60</b> | 58,00     | <b>69,60</b> | 64,00     | <b>76,80</b> |
|   | 026651    |              | 026675    |              | 026699    |              |
| <b>SB</b> 6<br>Šedo biela<br>RAL 9002   | 58,00     | <b>69,60</b> | 58,00     | <b>69,60</b> | 64,00     | <b>76,80</b> |
|   | 027559 *  |              | 027573    |              | 027597    |              |
| <b>BH</b> 7<br>Bielo hliníková<br>RAL 9006  | 58,00     | <b>69,60</b> | 58,00     | <b>69,60</b> | 64,00     | <b>76,80</b> |
|   | 026354    |              | 026378    |              | 026392    |              |
| <b>PS</b> 8<br>Prachovo šedá<br>RAL 7037  | 58,00     | <b>69,60</b> | 58,00     | <b>69,60</b> | 64,00     | <b>76,80</b> |
|   | 027405    |              | 027429    |              | 027443    |              |
| <b>MM</b> 9<br>Metalická medená<br>RAL extra  | 58,00     | <b>69,60</b> | 58,00     | <b>69,60</b> | 64,00     | <b>76,80</b> |
|   | 026804 *  |              | 026828    |              | 026842    |              |
| <b>BHT – P.20</b> 10<br>Bielo hliníková tmavá<br>RAL 9007   | 58,00     | <b>69,60</b> | 58,00     | <b>69,60</b> | 64,00     | <b>76,80</b> |
|   | 096210    |              | 096265    |              | 096319    |              |
| <b>MZ</b> 11<br>Machovo zelená<br>RAL 6005  | 58,00     | <b>69,60</b> | 58,00     | <b>69,60</b> | 64,00     | <b>76,80</b> |
|   | 027108 *  |              | 027122    |              | 027146 *  |              |
| <b>MOT</b> 12<br>Tmavo modrá<br>RAL 5010  | 58,00     | <b>69,60</b> | 58,00     | <b>69,60</b> | 64,00     | <b>76,80</b> |
|   | 026958 *  |              | 026972    |              | 027009 *  |              |
| <b>TZ</b> 13<br>Trávovo zelená<br>RAL 6011  | 58,00     | <b>69,60</b> | 58,00     | <b>69,60</b> | 64,00     | <b>76,80</b> |
|   | 027856 *  |              | 027870 *  |              | 027894 *  |              |
| <b>Balenie v ks</b>  | <b>2</b>  |              | <b>2</b>  |              | <b>2</b>  |              |
| <b>Balenie v ks</b>  | <b>36</b> |              | <b>36</b> |              | <b>36</b> |              |

\* Výroba na objednávku

## KOTLÍK ZBERNÝ DESING EXZENTRICKÝ

## P-PKLZ DX

| Menovitá veľkosť  | 80        |              | 100       |              | 120       |              |
|---|-----------|--------------|-----------|--------------|-----------|--------------|
|   | Bez DPH   | S DPH        | Bez DPH   | S DPH        | Bez DPH   | S DPH        |
| <b>TM</b> 1<br>Testa di Moro<br>RAL 8028  | 72,00     | <b>86,40</b> | 72,00     | <b>86,40</b> | 74,00     | <b>88,80</b> |
|   | 027764    |              | 027795    |              | 027825    |              |
| <b>AN</b> 2<br>Antracit<br>RAL 7016   | 72,00     | <b>86,40</b> | 72,00     | <b>86,40</b> | 74,00     | <b>88,80</b> |
|   | 026262    |              | 026293    |              | 026323    |              |
| <b>IC</b> 3<br>Intenzívna čierna<br>RAL 9005  | 72,00     | <b>86,40</b> | 72,00     | <b>86,40</b> | 74,00     | <b>88,80</b> |
|   | 026569    |              | 026590    |              | 026620 *  |              |
| <b>OC</b> 4<br>Oceľovo červená<br>RAL 3009  | 72,00     | <b>86,40</b> | 72,00     | <b>86,40</b> | 74,00     | <b>88,80</b> |
|   | 027313    |              | 027344    |              | 027375 *  |              |
| <b>MH</b> 5<br>Medeno hnedá<br>RAL 8004   | 72,00     | <b>86,40</b> | 72,00     | <b>86,40</b> | 74,00     | <b>88,80</b> |
|   | 026712 *  |              | 026743 *  |              | 026774 *  |              |
| <b>SB</b> 6<br>Šedo biela<br>RAL 9002   | 72,00     | <b>86,40</b> | 72,00     | <b>86,40</b> | 74,00     | <b>88,80</b> |
|   | 027610 *  |              | 027641    |              | 027672    |              |
| <b>BH</b> 7<br>Bielo hliníková<br>RAL 9006  | 72,00     | <b>86,40</b> | 72,00     | <b>86,40</b> | 74,00     | <b>88,80</b> |
|   | 026415 *  |              | 026446    |              | 026477    |              |
| <b>PS</b> 8<br>Prachovo šedá<br>RAL 7037  | 72,00     | <b>86,40</b> | 72,00     | <b>86,40</b> | 74,00     | <b>88,80</b> |
|   | 027467 *  |              | 027498    |              | 027528    |              |
| <b>MM</b> 9<br>Metalická medená<br>RAL extra  | 72,00     | <b>86,40</b> | 72,00     | <b>86,40</b> | 74,00     | <b>88,80</b> |
|   | 026866 *  |              | 026897    |              | 026927 *  |              |
| <b>BHT – P.20</b> 10<br>Bielo hliníková tmavá<br>RAL 9007   | 72,00     | <b>86,40</b> | 72,00     | <b>86,40</b> | 74,00     | <b>88,80</b> |
|   | 096203 *  |              | 096258    |              | 096302    |              |
| <b>MZ</b> 11<br>Machovo zelená<br>RAL 6005  | 72,00     | <b>86,40</b> | 72,00     | <b>86,40</b> | 74,00     | <b>88,80</b> |
|   | 027160 *  |              | 027191 *  |              | 027221 *  |              |
| <b>MOT</b> 12<br>Tmavo modrá<br>RAL 5010  | 72,00     | <b>86,40</b> | 72,00     | <b>86,40</b> | 74,00     | <b>88,80</b> |
|   | 027016 *  |              | 027047 *  |              | 027078 *  |              |
| <b>TZ</b> 13<br>Trávovo zelená<br>RAL 6011  | 72,00     | <b>86,40</b> | 72,00     | <b>86,40</b> | 74,00     | <b>88,80</b> |
|   | 027917 *  |              | 027948 *  |              | 027979 *  |              |
| <b>Balenie v ks</b>  | <b>2</b>  |              | <b>2</b>  |              | <b>2</b>  |              |
| <b>Balenie v ks</b>  | <b>36</b> |              | <b>36</b> |              | <b>36</b> |              |

\* Výroba na objednávku



### KOTLÍK ZBERNÝ KUBICKÝ

### P-PKLZ KU



| Menovitá veľkosť  | 80        |               | 100       |               | 120       |               |
|---|-----------|---------------|-----------|---------------|-----------|---------------|
|   | Bez DPH   | S DPH         | Bez DPH   | S DPH         | Bez DPH   | S DPH         |
| <b>TM</b> 1<br>Testa di Moro<br>RAL 8028                  | 88,00     | <b>105,60</b> | 88,00     | <b>105,60</b> | 94,00     | <b>112,80</b> |
|   | 027719 *  |               | 027733    |               | 027757    |               |
| <b>AN</b> 2<br>Antracit<br>RAL 7016                       | 88,00     | <b>105,60</b> | 88,00     | <b>105,60</b> | 94,00     | <b>112,80</b> |
|   | 026217    |               | 026231    |               | 026255    |               |
| <b>IC</b> 3<br>Intenzívna čierna<br>RAL 9005              | 88,00     | <b>105,60</b> | 88,00     | <b>105,60</b> | 94,00     | <b>112,80</b> |
|   | 026514    |               | 026538    |               | 026552    |               |
| <b>OC</b> 4<br>Oceľovo červená<br>RAL 3009                | 88,00     | <b>105,60</b> | 88,00     | <b>105,60</b> | 94,00     | <b>112,80</b> |
|   | 027269 *  |               | 027283 *  |               | 027306    |               |
| <b>MH</b> 5<br>Medeno hnedá<br>RAL 8004                   | 88,00     | <b>105,60</b> | 88,00     | <b>105,60</b> | 94,00     | <b>112,80</b> |
|   | 026668 *  |               | 026682 *  |               | 026705 *  |               |
| <b>SB</b> 6<br>Šedo biela<br>RAL 9002                     | 88,00     | <b>105,60</b> | 88,00     | <b>105,60</b> | 94,00     | <b>112,80</b> |
|   | 027566 *  |               | 027580 *  |               | 027603 *  |               |
| <b>BH</b> 7<br>Bielo hliníková<br>RAL 9006                | 88,00     | <b>105,60</b> | 88,00     | <b>105,60</b> | 94,00     | <b>112,80</b> |
|   | 026361 *  |               | 026385 *  |               | 026408    |               |
| <b>PS</b> 8<br>Prachovo šedá<br>RAL 7037                  | 88,00     | <b>105,60</b> | 88,00     | <b>105,60</b> | 94,00     | <b>112,80</b> |
|   | 027412 *  |               | 027436 *  |               | 027450    |               |
| <b>MM</b> 9<br>Metalická medená<br>RAL extra              | 88,00     | <b>105,60</b> | 88,00     | <b>105,60</b> | 94,00     | <b>112,80</b> |
|   | 026811 *  |               | 026835 *  |               | 026859 *  |               |
| <b>BHT – P.20</b> 10<br>Bielo hliníková tmavá<br>RAL 9007 | 88,00     | <b>105,60</b> | 88,00     | <b>105,60</b> | 94,00     | <b>112,80</b> |
|   | 096241 *  |               | 096296    |               | 096340 *  |               |
| <b>MZ</b> 11<br>Machovo zelená<br>RAL 6005                | 88,00     | <b>105,60</b> | 88,00     | <b>105,60</b> | 94,00     | <b>112,80</b> |
|   | 027115 *  |               | 027139 *  |               | 027153 *  |               |
| <b>MOT</b> 12<br>Tmavo modrá<br>RAL 5010                  | 88,00     | <b>105,60</b> | 88,00     | <b>105,60</b> | 94,00     | <b>112,80</b> |
|   | 026965 *  |               | 026989 *  |               | 026996 *  |               |
| <b>TZ</b> 13<br>Trávovo zelená<br>RAL 6011                | 88,00     | <b>105,60</b> | 88,00     | <b>105,60</b> | 94,00     | <b>112,80</b> |
|   | 027863 *  |               | 027887 *  |               | 027900 *  |               |
| <b>Balenie v ks</b> 📦                                     | <b>2</b>  |               | <b>2</b>  |               | <b>2</b>  |               |
| <b>Balenie v ks</b> 🚚                                     | <b>36</b> |               | <b>36</b> |               | <b>36</b> |               |

\* Výroba na objednávku

## KOTLÍK ZBERNÝ KUBICKÝ EXZENTRICKÝ

P-PKLZ KX



| Menovitá veľkosť  | 80        |               | 100       |               | 120       |               |
|---|-----------|---------------|-----------|---------------|-----------|---------------|
|   | Bez DPH   | S DPH         | Bez DPH   | S DPH         | Bez DPH   | S DPH         |
| <b>TM</b> 1<br>Testa di Moro<br>RAL 8028  | 88,00     | <b>105,60</b> | 88,00     | <b>105,60</b> | 94,00     | <b>112,80</b> |
|   | 027788    |               | 027818    |               | 027849    |               |
| <b>AN</b> 2<br>Antracit<br>RAL 7016   | 88,00     | <b>105,60</b> | 88,00     | <b>105,60</b> | 94,00     | <b>112,80</b> |
|   | 026286    |               | 026316    |               | 026347    |               |
| <b>IC</b> 3<br>Intenzívna čierna<br>RAL 9005  | 88,00     | <b>105,60</b> | 88,00     | <b>105,60</b> | 94,00     | <b>112,80</b> |
|   | 026583    |               | 026613    |               | 026644 *  |               |
| <b>OC</b> 4<br>Oceľovo červená<br>RAL 3009  | 88,00     | <b>105,60</b> | 88,00     | <b>105,60</b> | 94,00     | <b>112,80</b> |
|   | 027337 *  |               | 027368    |               | 027399    |               |
| <b>MH</b> 5<br>Medeno hnedá<br>RAL 8004   | 88,00     | <b>105,60</b> | 88,00     | <b>105,60</b> | 94,00     | <b>112,80</b> |
|   | 026736    |               | 026767    |               | 026798 *  |               |
| <b>SB</b> 6<br>Šedo biela<br>RAL 9002   | 88,00     | <b>105,60</b> | 88,00     | <b>105,60</b> | 94,00     | <b>112,80</b> |
|   | 027634 *  |               | 027665    |               | 027696    |               |
| <b>BH</b> 7<br>Bielo hliníková<br>RAL 9006  | 88,00     | <b>105,60</b> | 88,00     | <b>105,60</b> | 94,00     | <b>112,80</b> |
|   | 026439 *  |               | 026460    |               | 026491    |               |
| <b>PS</b> 8<br>Prachovo šedá<br>RAL 7037  | 88,00     | <b>105,60</b> | 88,00     | <b>105,60</b> | 94,00     | <b>112,80</b> |
|   | 027481 *  |               | 027511    |               | 027542    |               |
| <b>MM</b> 9<br>Metalická medená<br>RAL extra  | 88,00     | <b>105,60</b> | 88,00     | <b>105,60</b> | 94,00     | <b>112,80</b> |
|   | 026880 *  |               | 026910    |               | 026941 *  |               |
| <b>BHT – P.20</b> 10<br>Bielo hliníková tmavá<br>RAL 9007   | 88,00     | <b>105,60</b> | 88,00     | <b>105,60</b> | 94,00     | <b>112,80</b> |
|   | 096227    |               | 096272    |               | 096326    |               |
| <b>MZ</b> 11<br>Machovo zelená<br>RAL 6005  | 88,00     | <b>105,60</b> | 88,00     | <b>105,60</b> | 94,00     | <b>112,80</b> |
|   | 027184 *  |               | 027214    |               | 027245 *  |               |
| <b>MOT</b> 12<br>Tmavo modrá<br>RAL 5010  | 88,00     | <b>105,60</b> | 88,00     | <b>105,60</b> | 94,00     | <b>112,80</b> |
|   | 027030 *  |               | 027061 *  |               | 027092 *  |               |
| <b>TZ</b> 13<br>Trávovo zelená<br>RAL 6011  | 88,00     | <b>105,60</b> | 88,00     | <b>105,60</b> | 94,00     | <b>112,80</b> |
|   | 027931 *  |               | 027962    |               | 027993 *  |               |
| <b>Balenie v ks</b>  | <b>2</b>  |               | <b>2</b>  |               | <b>2</b>  |               |
| <b>Balenie v ks</b>  | <b>36</b> |               | <b>36</b> |               | <b>36</b> |               |

\* Výroba na objednávku

### KOTLÍK ZBERNÝ KUBICKÝ EXZENTRICKÝ VÝTOK

### P-PKLZ KXV





| Menovitá veľkosť  | 80        |               | 100       |               | 120       |               |
|---|-----------|---------------|-----------|---------------|-----------|---------------|
|   | Bez DPH   | S DPH         | Bez DPH   | S DPH         | Bez DPH   | S DPH         |
| <b>TM</b> 1<br>Testa di Moro<br>RAL 8028  | 115,00    | <b>138,00</b> | 115,00    | <b>138,00</b> | 115,00    | <b>138,00</b> |
|   | 027771 *  |               | 027801 *  |               | 027832 *  |               |
| <b>AN</b> 2<br>Antracit<br>RAL 7016   | 115,00    | <b>138,00</b> | 115,00    | <b>138,00</b> | 115,00    | <b>138,00</b> |
|   | 026279 *  |               | 026309 *  |               | 026330 *  |               |
| <b>IC</b> 3<br>Intenzívna čierna<br>RAL 9005  | 115,00    | <b>138,00</b> | 115,00    | <b>138,00</b> | 115,00    | <b>138,00</b> |
|   | 026576 *  |               | 026606    |               | 026637 *  |               |
| <b>OC</b> 4<br>Oceľovo červená<br>RAL 3009  | 115,00    | <b>138,00</b> | 115,00    | <b>138,00</b> | 115,00    | <b>138,00</b> |
|   | 027320 *  |               | 027351 *  |               | 027382 *  |               |
| <b>MH</b> 5<br>Medeno hnedá<br>RAL 8004   | 115,00    | <b>138,00</b> | 115,00    | <b>138,00</b> | 115,00    | <b>138,00</b> |
|   | 026729 *  |               | 026750 *  |               | 026781 *  |               |
| <b>SB</b> 6<br>Šedo biela<br>RAL 9002   | 115,00    | <b>138,00</b> | 115,00    | <b>138,00</b> | 115,00    | <b>138,00</b> |
|   | 027627 *  |               | 027658 *  |               | 027689 *  |               |
| <b>BH</b> 7<br>Bielo hliníková<br>RAL 9006  | 115,00    | <b>138,00</b> | 115,00    | <b>138,00</b> | 115,00    | <b>138,00</b> |
|   | 026422 *  |               | 026453 *  |               | 026484 *  |               |
| <b>PS</b> 8<br>Prachovo šedá<br>RAL 7037  | 115,00    | <b>138,00</b> | 115,00    | <b>138,00</b> | 115,00    | <b>138,00</b> |
|   | 027474 *  |               | 027504 *  |               | 027535 *  |               |
| <b>MM</b> 9<br>Metalická medená<br>RAL extra  | 115,00    | <b>138,00</b> | 115,00    | <b>138,00</b> | 115,00    | <b>138,00</b> |
|   | 026873 *  |               | 026903 *  |               | 026934 *  |               |
| <b>BHT – P.20</b> 10<br>Bielo hliníková tmavá<br>RAL 9007   | 115,00    | <b>138,00</b> | 115,00    | <b>138,00</b> | 115,00    | <b>138,00</b> |
|   | 096234 *  |               | 096289 *  |               | 096333 *  |               |
| <b>MZ</b> 11<br>Machovo zelená<br>RAL 6005  | 115,00    | <b>138,00</b> | 115,00    | <b>138,00</b> | 115,00    | <b>138,00</b> |
|   | 027177 *  |               | 027207 *  |               | 027238 *  |               |
| <b>MOT</b> 12<br>Tmavo modrá<br>RAL 5010  | 115,00    | <b>138,00</b> | 115,00    | <b>138,00</b> | 115,00    | <b>138,00</b> |
|   | 027023 *  |               | 027054 *  |               | 027085 *  |               |
| <b>TZ</b> 13<br>Trávovo zelená<br>RAL 6011  | 115,00    | <b>138,00</b> | 115,00    | <b>138,00</b> | 115,00    | <b>138,00</b> |
|   | 027924 *  |               | 027955 *  |               | 027986 *  |               |
| <b>Balenie v ks</b>  | <b>2</b>  |               | <b>2</b>  |               | <b>2</b>  |               |
| <b>Balenie v ks</b>  | <b>36</b> |               | <b>36</b> |               | <b>36</b> |               |

\* Výroba na objednávku

**EPDM TESNIACA GUMA ZBERNÉHO KOTLIČKA**

**P-PKLZ T**



| Menovitá veľkosť  | EAN číslo výrobku | Balenie v ks  |   | Cena [€/ks] |             |
|-------------------|-------------------|---|---|-------------|-------------|
|                   |                   |  |  | Bez DPH     | S DPH       |
| <b>IC 70-85</b>   | 077103            | 5   | 600   | 3,90        | <b>4,68</b> |
| <b>IC 100-110</b> | 077110            | 5   | 600   | 4,00        | <b>4,80</b> |
| <b>IC 110-125</b> | 077097            | 5   | 600   | 4,10        | <b>4,92</b> |
| <b>PS 70-85</b>   | 077134            | 5   | 600   | 4,30        | <b>5,16</b> |
| <b>PS 100-110</b> | 077141            | 5   | 600   | 4,75        | <b>5,70</b> |
| <b>PS 110-125</b> | 077127            | 5   | 600   | 4,90        | <b>5,88</b> |

**POZINK**  
POLYESTER

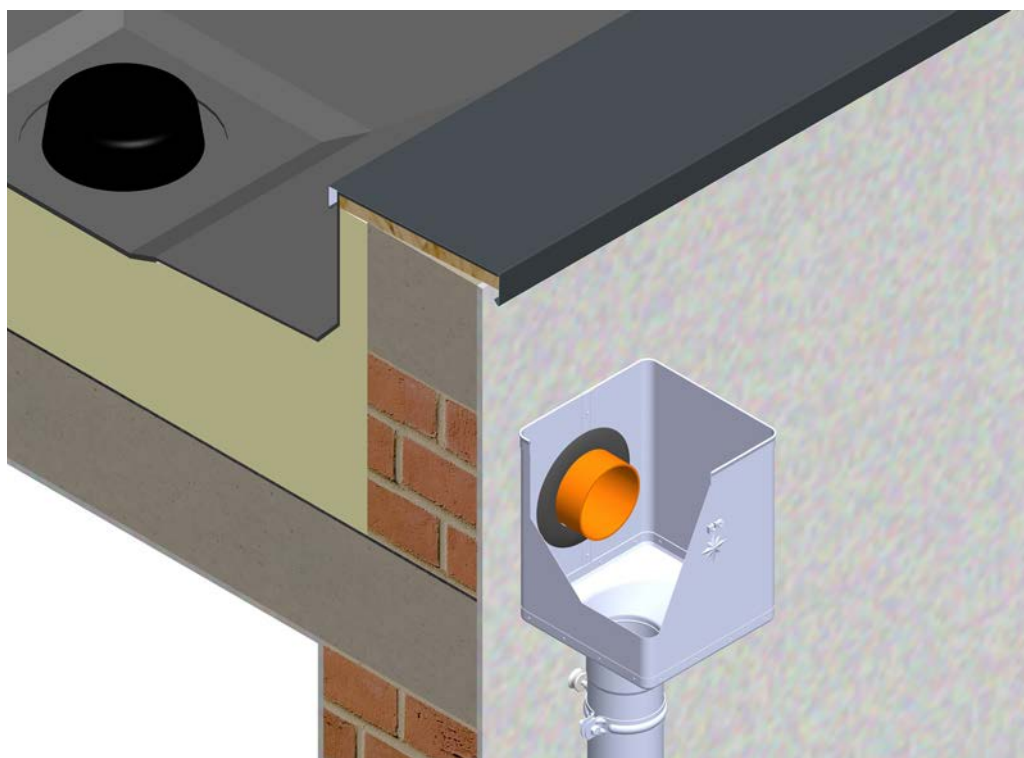



### ZVODOVÉ KOLENO HRANATÉ 72°

PH-PKH

| Menovitá veľkosť  | 80/80      |              | 100/100    |              | 120/120 MAFA |              | 150/150 MAFA |              |
|---|------------|--------------|------------|--------------|--------------|--------------|--------------|--------------|
|   | Bez DPH    | S DPH        | Bez DPH    | S DPH        | Bez DPH      | S DPH        | Bez DPH      | S DPH        |
| <b>TM</b> 1<br>Testa di Moro<br>RAL 8028  | 12,50      | <b>15,00</b> | 13,50      | <b>16,20</b> | 17,50        | <b>21,00</b> | 22,00        | <b>26,40</b> |
|   | 020178     |              | 020185     |              | 020192       |              | 020208 *     |              |
| <b>AN</b> 2<br>Antracit<br>RAL 7016   | 12,50      | <b>15,00</b> | 13,50      | <b>16,20</b> | 17,50        | <b>21,00</b> | 22,00        | <b>26,40</b> |
|   | 019776     |              | 019783     |              | 019790       |              | 019806       |              |
| <b>IC</b> 3<br>Intenzívna čierna<br>RAL 9005  | 12,50      | <b>15,00</b> | 13,50      | <b>16,20</b> | 17,50        | <b>21,00</b> | 22,00        | <b>26,40</b> |
|   | 019851     |              | 019868     |              | 019875       |              | 019882 *     |              |
| <b>OC</b> 4<br>Oceľovo červená<br>RAL 3009  | 12,50      | <b>15,00</b> | 13,50      | <b>16,20</b> | 17,50        | <b>21,00</b> | 22,00        | <b>26,40</b> |
|   | 020055     |              | 020062     |              | 020079 *     |              | 020086 *     |              |
| <b>MH</b> 5<br>Medeno hnedá<br>RAL 8004   | 12,50      | <b>15,00</b> | 13,50      | <b>16,20</b> | 17,50        | <b>21,00</b> | 22,00        | <b>26,40</b> |
|   | 019899 *   |              | 019905     |              | 019912 *     |              | 019929 *     |              |
| <b>SB</b> 6<br>Šedo biela<br>RAL 9002   | 12,50      | <b>15,00</b> | 13,50      | <b>16,20</b> | 17,50        | <b>21,00</b> | 22,00        | <b>26,40</b> |
|   | 020130     |              | 020147     |              | 020154       |              | 020161 *     |              |
| <b>BH</b> 7<br>Bielo hliníková<br>RAL 9006  | 12,50      | <b>15,00</b> | 13,50      | <b>16,20</b> | 17,50        | <b>21,00</b> | 22,00        | <b>26,40</b> |
|   | 019813     |              | 019820     |              | 019837       |              | 019844       |              |
| <b>PS</b> 8<br>Prachovo šedá<br>RAL 7037  | 12,50      | <b>15,00</b> | 13,50      | <b>16,20</b> | 17,50        | <b>21,00</b> | 22,00        | <b>26,40</b> |
|   | 020093     |              | 020109     |              | 020116       |              | 020123 *     |              |
| <b>MM</b> 9<br>Metalická medená<br>RAL extra  | 12,50      | <b>15,00</b> | 13,50      | <b>16,20</b> | 17,50        | <b>21,00</b> | 22,00        | <b>26,40</b> |
|   | 019936 *   |              | 019943 *   |              | 019950 *     |              | 019967 *     |              |
| <b>BHT – P.20</b> 10<br>Bielo hliníková tmavá<br>RAL 9007   |            |              |            |              |              |              |              |              |
| <b>MZ</b> 11<br>Machovo zelená<br>RAL 6005  | 12,50      | <b>15,00</b> | 13,50      | <b>16,20</b> | 17,50        | <b>21,00</b> | 22,00        | <b>26,40</b> |
|   | 020017 *   |              | 020024 *   |              | 020031 *     |              | 020048 *     |              |
| <b>MOT</b> 12<br>Tmavo modrá<br>RAL 5010  | 12,50      | <b>15,00</b> | 13,50      | <b>16,20</b> | 17,50        | <b>21,00</b> | 22,00        | <b>26,40</b> |
|   | 019974 *   |              | 019981 *   |              | 019998 *     |              | 020000 *     |              |
| <b>TZ</b> 13<br>Trávovo zelená<br>RAL 6011  | 12,50      | <b>15,00</b> | 13,50      | <b>16,20</b> | 17,50        | <b>21,00</b> | 22,00        | <b>26,40</b> |
|   | 020215 *   |              | 020222 *   |              | 020239 *     |              | 020246 *     |              |
| <b>Balenie v ks</b>  | <b>6</b>   |              | <b>6</b>   |              | <b>4</b>     |              | <b>2</b>     |              |
| <b>Balenie v ks</b>  | <b>240</b> |              | <b>180</b> |              | <b>60</b>    |              | <b>24</b>    |              |

\* Výroba na objednávku  
**MAFA** – Manufaktúra (ručná výroba)

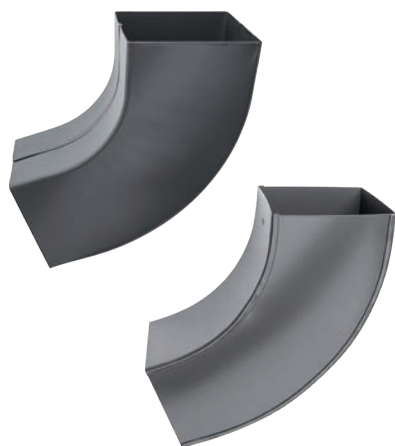

**ZVODOVÁ RÚRA HRANATÁ [s=0,55]**
**PH-ZRH**

| Menovitá veľkosť  | 80/80      |              | 80/80      |              | 100/100    |              | 100/100    |              |
|---|------------|--------------|------------|--------------|------------|--------------|------------|--------------|
|   | Dĺžka v m  |              | Dĺžka v m  |              | Dĺžka v m  |              | Dĺžka v m  |              |
| Cena v €/m  | 3,0        |              | 4,0        |              | 3,0        |              | 4,0        |              |
|   | Bez DPH    | S DPH        | Bez DPH    | S DPH        | Bez DPH    | S DPH        | Bez DPH    | S DPH        |
| <b>TM</b> 1<br>Testa di Moro<br>RAL 8028                  | 11,90      | <b>14,28</b> | 11,90      | <b>14,28</b> | 12,30      | <b>14,76</b> | 12,30      | <b>14,76</b> |
|   | 023773     |              | 023780     |              | 023803     |              | 023810     |              |
| <b>AN</b> 2<br>Antracit<br>RAL 7016                       | 11,90      | <b>14,28</b> |            |              | 12,30      | <b>14,76</b> | 12,30      | <b>14,76</b> |
|   | 023131     |              |            |              | 023162     |              | 023179     |              |
| <b>IC</b> 3<br>Intenzívna čierna<br>RAL 9005              | 11,90      | <b>14,28</b> |            |              | 12,30      | <b>14,76</b> | 12,30      | <b>14,76</b> |
|   | 023292     |              |            |              | 023315     |              | 023322     |              |
| <b>OC</b> 4<br>Oceľovo červená<br>RAL 3009                | 11,90      | <b>14,28</b> |            |              | 12,30      | <b>14,76</b> |            |              |
|   | 023575 *   |              |            |              | 023599     |              |            |              |
| <b>MH</b> 5<br>Medeno hnedá<br>RAL 8004                   | 12,10      | <b>14,52</b> |            |              | 12,50      | <b>15,00</b> |            |              |
|   | 023360 *   |              |            |              | 023384     |              |            |              |
| <b>SB</b> 6<br>Šedo biela<br>RAL 9002                     | 12,10      | <b>14,52</b> |            |              | 12,50      | <b>15,00</b> |            |              |
|   | 023711     |              |            |              | 023735     |              |            |              |
| <b>BH</b> 7<br>Bielo hliníková<br>RAL 9006                | 12,10      | <b>14,52</b> |            |              | 12,50      | <b>15,00</b> | 12,50      | <b>15,00</b> |
|   | 023216     |              |            |              | 023247     |              | 023254     |              |
| <b>PS</b> 8<br>Prachovo šedá<br>RAL 7037                  | 12,10      | <b>14,52</b> |            |              | 12,50      | <b>15,00</b> | 12,50      | <b>15,00</b> |
|   | 023636     |              |            |              | 023667     |              | 023674     |              |
| <b>MM</b> 9<br>Metalická medená<br>RAL extra              | 12,30      | <b>14,76</b> |            |              | 12,70      | <b>15,24</b> |            |              |
|   | 023414 *   |              |            |              | 023438     |              |            |              |
| <b>BHT – P.20</b> 10<br>Bielo hliníková tmavá<br>RAL 9007 |            |              |            |              |            |              |            |              |
| <b>MZ</b> 11<br>Machovo zelená<br>RAL 6005                | 12,30      | <b>14,76</b> |            |              | 12,70      | <b>15,24</b> |            |              |
|   | 023520 *   |              |            |              | 023544     |              |            |              |
| <b>MOT</b> 12<br>Tmavo modrá<br>RAL 5010                  | 12,30      | <b>14,76</b> |            |              | 12,70      | <b>15,24</b> |            |              |
|   | 023469 *   |              |            |              | 023483     |              |            |              |
| <b>TZ</b> 13<br>Trávovo zelená<br>RAL 6011                | 12,30      | <b>14,76</b> |            |              | 12,70      | <b>15,24</b> |            |              |
|   | 023841 *   |              |            |              | 023858     |              |            |              |
| <b>Balenie v m</b>  | <b>3</b>   |              | <b>4</b>   |              | <b>3</b>   |              | <b>4</b>   |              |
| <b>Balenie v m</b>  | <b>324</b> |              | <b>432</b> |              | <b>210</b> |              | <b>280</b> |              |

\* Výroba na objednávku

 POZINK  
 POLYESTER

## ZVODOVÁ RÚRA HRANATÁ [s=0,55]

PH-ZRH



| Menovitá veľkosť  | 120/120    |              | 150/150 <b>MAFA</b> |              |
|---|------------|--------------|---------------------|--------------|
|   | 3,0        |              | 3,0                 |              |
| Dĺžka v m   | 3,0        |              | 3,0                 |              |
| Cena v €/m  | Bez DPH    | S DPH        | Bez DPH             | S DPH        |
| <b>TM</b> 1<br>Testa di Moro<br>RAL 8028                  | 23,00      | <b>27,60</b> | 24,00               | <b>28,80</b> |
|   | 023827     |              | 023834 *            |              |
| <b>AN</b> 2<br>Antracit<br>RAL 7016                       | 23,00      | <b>27,60</b> | 24,00               | <b>28,80</b> |
|   | 023186     |              | 023193              |              |
| <b>IC</b> 3<br>Intenzívna čierna<br>RAL 9005              | 23,00      | <b>27,60</b> | 24,00               | <b>28,80</b> |
|   | 023339     |              | 023346 *            |              |
| <b>OC</b> 4<br>Oceľovo červená<br>RAL 3009                | 23,00      | <b>27,60</b> | 24,00               | <b>28,80</b> |
|   | 023605 *   |              | 023612 *            |              |
| <b>MH</b> 5<br>Medeno hnedá<br>RAL 8004                   | 23,20      | <b>27,84</b> | 24,20               | <b>29,04</b> |
|   | 023391 *   |              | 023407 *            |              |
| <b>SB</b> 6<br>Šedo biela<br>RAL 9002                     | 23,20      | <b>27,84</b> | 24,20               | <b>29,04</b> |
|   | 023742     |              | 023759 *            |              |
| <b>BH</b> 7<br>Bielo hliníková<br>RAL 9006                | 23,20      | <b>27,84</b> | 24,20               | <b>29,04</b> |
|   | 023261     |              | 023278              |              |
| <b>PS</b> 8<br>Prachovo šedá<br>RAL 7037                  | 23,20      | <b>27,84</b> | 24,20               | <b>29,04</b> |
|   | 023681     |              | 023698              |              |
| <b>MM</b> 9<br>Metalická medená<br>RAL extra              | 23,40      | <b>28,08</b> | 24,40               | <b>29,28</b> |
|   | 023445 *   |              | 023452 *            |              |
| <b>BHT – P.20</b> 10<br>Bielo hliníková tmavá<br>RAL 9007 |            |              |                     |              |
| <b>MZ</b> 11<br>Machovo zelená<br>RAL 6005                | 23,40      | <b>28,08</b> | 24,40               | <b>29,28</b> |
|   | 023551 *   |              | 023568 *            |              |
| <b>MOT</b> 12<br>Tmavo modrá<br>RAL 5010                  | 23,40      | <b>28,08</b> | 24,40               | <b>29,28</b> |
|   | 023490 *   |              | 023506 *            |              |
| <b>TZ</b> 13<br>Trávovo zelená<br>RAL 6011                | 23,40      | <b>28,08</b> | 24,40               | <b>29,28</b> |
|   | 023865 *   |              | 023872 *            |              |
| <b>Balenie v m</b>  | <b>3</b>   |              | <b>6</b>            |              |
| <b>Balenie v m</b>  | <b>120</b> |              | <b>60</b>           |              |

\* Výroba na objednávku  
**MAFA** – Manufaktúra (ručná výroba)

## ZVODOVÉ KOLENO ODSKOKOVÉ HRANATÉ

PH-PKOH

| Menovitá veľkosť  | 80/80 MAFA |              | 100/100 MAFA |              | 120/120 MAFA |              |
|---|------------|--------------|--------------|--------------|--------------|--------------|
|   | Bez DPH    | S DPH        | Bez DPH      | S DPH        | Bez DPH      | S DPH        |
| <b>TM</b> 1<br>Testa di Moro<br>RAL 8028  | 17,00      | <b>20,40</b> | 17,50        | <b>21,00</b> | 19,00        | <b>22,80</b> |
|   | 020611     |              | 020628       |              | 020635       |              |
| <b>AN</b> 2<br>Antracit<br>RAL 7016   | 17,00      | <b>20,40</b> | 17,50        | <b>21,00</b> | 19,00        | <b>22,80</b> |
|   | 020314     |              | 020321       |              | 020338       |              |
| <b>IC</b> 3<br>Intenzívna čierna<br>RAL 9005  | 17,00      | <b>20,40</b> | 17,50        | <b>21,00</b> | 19,00        | <b>22,80</b> |
|   | 020376     |              | 020383       |              | 020390 *     |              |
| <b>OC</b> 4<br>Oceľovo červená<br>RAL 3009  | 17,00      | <b>20,40</b> | 17,50        | <b>21,00</b> | 19,00        | <b>22,80</b> |
|   | 020529 *   |              | 020536 *     |              | 020543 *     |              |
| <b>MH</b> 5<br>Medeno hnedá<br>RAL 8004   | 17,00      | <b>20,40</b> | 17,50        | <b>21,00</b> | 19,00        | <b>22,80</b> |
|   | 020406 *   |              | 020413 *     |              | 020420 *     |              |
| <b>SB</b> 6<br>Šedo biela<br>RAL 9002   | 17,00      | <b>20,40</b> | 17,50        | <b>21,00</b> | 19,00        | <b>22,80</b> |
|   | 020581 *   |              | 020598       |              | 020604 *     |              |
| <b>BH</b> 7<br>Bielo hliníková<br>RAL 9006  | 17,00      | <b>20,40</b> | 17,50        | <b>21,00</b> | 19,00        | <b>22,80</b> |
|   | 020345     |              | 020352       |              | 020369 *     |              |
| <b>PS</b> 8<br>Prachovo šedá<br>RAL 7037  | 17,00      | <b>20,40</b> | 17,50        | <b>21,00</b> | 19,00        | <b>22,80</b> |
|   | 020550     |              | 020567       |              | 020574       |              |
| <b>MM</b> 9<br>Metalická medená<br>RAL extra  | 17,00      | <b>20,40</b> | 17,50        | <b>21,00</b> | 19,00        | <b>22,80</b> |
|   | 020437 *   |              | 020444 *     |              | 020451 *     |              |
| <b>BHT – P.20</b> 10<br>Bielo hliníková tmavá<br>RAL 9007   |            |              |              |              |              |              |
| <b>MZ</b> 11<br>Machovo zelená<br>RAL 6005  | 17,00      | <b>20,40</b> | 17,50        | <b>21,00</b> | 19,00        | <b>22,80</b> |
|   | 020499 *   |              | 020505 *     |              | 020512 *     |              |
| <b>MOT</b> 12<br>Tmavo modrá<br>RAL 5010  | 17,00      | <b>20,40</b> | 17,50        | <b>21,00</b> | 19,00        | <b>22,80</b> |
|   | 020468 *   |              | 020475 *     |              | 020482 *     |              |
| <b>TZ</b> 13<br>Trávovo zelená<br>RAL 6011  | 17,00      | <b>20,40</b> | 17,50        | <b>21,00</b> | 19,00        | <b>22,80</b> |
|   | 020642 *   |              | 020659 *     |              | 020666 *     |              |
| <b>Balenie v ks</b>  | <b>6</b>   |              | <b>6</b>     |              | <b>4</b>     |              |
| <b>Balenie v ks</b>  | <b>240</b> |              | <b>180</b>   |              | <b>120</b>   |              |

\* Výroba na objednávku  
MAFA – Manufaktúra (ručná výroba)



## ZVODOVÁ OBJÍMKA HRANATÁ M10

PH-POBH

| Menovitá veľkosť  | 80/80        |             | 100/100      |             | 120/120      |             | 150/150      |             |
|---|--------------|-------------|--------------|-------------|--------------|-------------|--------------|-------------|
|   | Bez DPH      | S DPH       | Bez DPH      | S DPH       | Bez DPH      | S DPH       | Bez DPH      | S DPH       |
| <b>TM</b> 1<br>Testa di Moro<br>RAL 8028                  | 3,80         | <b>4,56</b> | 3,85         | <b>4,62</b> | 4,10         | <b>4,92</b> | 5,80         | <b>6,96</b> |
|   | 024848       |             | 024855       |             | 024862       |             | 024879 *     |             |
| <b>AN</b> 2<br>Antracit<br>RAL 7016                       | 3,80         | <b>4,56</b> | 3,85         | <b>4,62</b> | 4,10         | <b>4,92</b> | 5,80         | <b>6,96</b> |
|   | 024442       |             | 024459       |             | 024466       |             | 024473       |             |
| <b>IC</b> 3<br>Intenzívna čierna<br>RAL 9005              | 3,80         | <b>4,56</b> | 3,85         | <b>4,62</b> | 4,10         | <b>4,92</b> | 5,80         | <b>6,96</b> |
|   | 024527       |             | 024534       |             | 024541       |             | 024558 *     |             |
| <b>OC</b> 4<br>Oceľovo červená<br>RAL 3009                | 3,80         | <b>4,56</b> | 3,85         | <b>4,62</b> | 4,10         | <b>4,92</b> | 5,80         | <b>6,96</b> |
|   | 024725       |             | 024732       |             | 024749 *     |             | 024756 *     |             |
| <b>MH</b> 5<br>Medeno hnedá<br>RAL 8004                   | 3,80         | <b>4,56</b> | 3,85         | <b>4,62</b> | 4,10         | <b>4,92</b> | 5,80         | <b>6,96</b> |
|   | 024565 *     |             | 024572 *     |             | 024589 *     |             | 024596 *     |             |
| <b>SB</b> 6<br>Šedo biela<br>RAL 9002                     | 3,80         | <b>4,56</b> | 3,85         | <b>4,62</b> | 4,10         | <b>4,92</b> | 5,80         | <b>6,96</b> |
|   | 024800       |             | 024817       |             | 024824       |             | 024831 *     |             |
| <b>BH</b> 7<br>Bielo hliníková<br>RAL 9006                | 3,80         | <b>4,56</b> | 3,85         | <b>4,62</b> | 4,10         | <b>4,92</b> | 5,80         | <b>6,96</b> |
|   | 024480       |             | 024497       |             | 024503       |             | 024510       |             |
| <b>PS</b> 8<br>Prachovo šedá<br>RAL 7037                  | 3,80         | <b>4,56</b> | 3,85         | <b>4,62</b> | 4,10         | <b>4,92</b> | 5,80         | <b>6,96</b> |
|   | 024763       |             | 024770       |             | 024787       |             | 024794 *     |             |
| <b>MM</b> 9<br>Metalická medená<br>RAL extra              | 3,80         | <b>4,56</b> | 3,85         | <b>4,62</b> | 4,10         | <b>4,92</b> | 5,80         | <b>6,96</b> |
|   | 024602 *     |             | 024619 *     |             | 024626 *     |             | 024633 *     |             |
| <b>BHT – P.20</b> 10<br>Bielo hliníková tmavá<br>RAL 9007 |              |             |              |             |              |             |              |             |
| <b>MZ</b> 11<br>Machovo zelená<br>RAL 6005                | 3,80         | <b>4,56</b> | 3,85         | <b>4,62</b> | 4,10         | <b>4,92</b> | 5,80         | <b>6,96</b> |
|   | 024688 *     |             | 024695 *     |             | 024701 *     |             | 024718 *     |             |
| <b>MOT</b> 12<br>Tmavo modrá<br>RAL 5010                  | 3,80         | <b>4,56</b> | 3,85         | <b>4,62</b> | 4,10         | <b>4,92</b> | 5,80         | <b>6,96</b> |
|   | 024640 *     |             | 024657 *     |             | 024664 *     |             | 024671 *     |             |
| <b>TZ</b> 13<br>Trávovo zelená<br>RAL 6011                | 3,80         | <b>4,56</b> | 3,85         | <b>4,62</b> | 4,10         | <b>4,92</b> | 5,80         | <b>6,96</b> |
|   | 024886 *     |             | 024893 *     |             | 024909 *     |             | 024916 *     |             |
| <b>Balenie v ks</b> 📦                                     | <b>10</b>    |             | <b>10</b>    |             | <b>10</b>    |             | <b>5</b>     |             |
| <b>Balenie v ks</b> 🚚                                     | <b>1 200</b> |             | <b>1 200</b> |             | <b>1 200</b> |             | <b>1 200</b> |             |

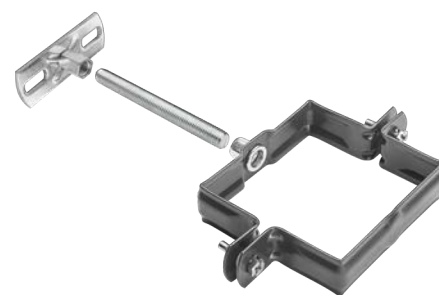
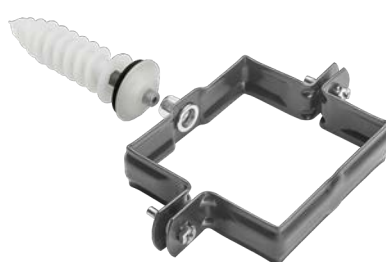
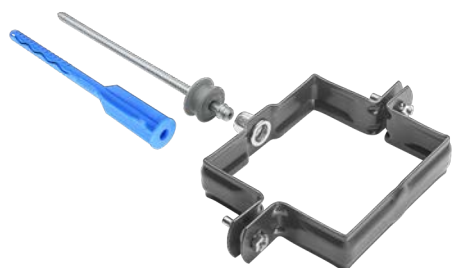

\* Výroba na objednávku



## NEREZOVÁ SKRUTKA S PVC PODLOŽKOU M6x20

P-POB-NSK





| Menovitá veľkosť | EAN číslo výrobku | Balenie v ks  |   | Cena [€/ks] |       |
|------------------|-------------------|---|---|-------------|-------|
|                  |                   |  |  | Bez DPH     | S DPH |
| M6 x 20 *        | 071675            | 1   | –   | 0,18        | 0,22  |

## ZÁVITOVÝ HROT TORX M10

P-POB-HT





POZINK  
POLYESTER

| Menovitá veľkosť | EAN číslo výrobku | Balenie v ks  |   | Cena [€/ks] |       |
|------------------|-------------------|---|---|-------------|-------|
|                  |                   |  |  | Bez DPH     | S DPH |
| 80               | 002464            | 100   | 40 000  | 0,77        | 0,92  |
| 140              | 002471            | 100   | 28 000  | 1,03        | 1,24  |
| 200              | 002488            | 100   | 20 000  | 1,31        | 1,57  |
| 250              | 002495            | 100   | 17 000  | 1,47        | 1,76  |
| 300              | 002501            | 100   | 11 200  | 1,52        | 1,82  |

## HMOŽDINKA MODRÁ BEZ LAMELY M10

P-POB-HN DB





| Menovitá veľkosť | EAN číslo výrobku | Balenie v ks  |   | Cena [€/ks] |       |
|------------------|-------------------|---|---|-------------|-------|
|                  |                   |  |  | Bez DPH     | S DPH |
| 120              | 002426            | 100   | 25 000  | 0,37        | 0,44  |

## HMOŽDINKA MODRÁ S LAMELOU M10

P-POB-HN DB





| Menovitá veľkosť | EAN číslo výrobku | Balenie v ks  |   | Cena [€/ks] |       |
|------------------|-------------------|---|---|-------------|-------|
|                  |                   |  |  | Bez DPH     | S DPH |
| 180              | 002433            | 100   | 12 000  | 0,38        | 0,46  |
| 240              | 002440            | 100   | 12 000  | 0,45        | 0,54  |
| 280              | 002457            | 100   | 12 000  | 0,48        | 0,58  |

## KOMBISKRUTKA TORX M10

P-POB-ZT/SZ



| Menovitá veľkosť | EAN číslo výrobku | Balenie v ks  |   | Cena [€/ks] |       |
|------------------|-------------------|---|---|-------------|-------|
|                  |                   |  |  | Bez DPH     | S DPH |
| 140              | 002587            | 50  | 10 400  | 0,44        | 0,53  |
| 180              | 002594            | 50  | 10 400  | 0,56        | 0,67  |

## NYLON IZOLAČNÁ HMOŽDINKA S OCHRANNOU KRYTKOU M10

P-POB-HN IZOL



| Menovitá veľkosť | EAN číslo výrobku | Balenie v ks |       | Cena [€/ks] |       |
|------------------|-------------------|--------------|-------|-------------|-------|
|                  |                   |              |       | Bez DPH     | S DPH |
| M10 x 96         | 001207            | 25           | 5 000 | 4,88        | 5,86  |

## ZÁVITOVÁ TYČ M10

P-POB-ZT



| Menovitá veľkosť | EAN číslo výrobku | Balenie v ks |        | Cena [€/ks] |       |
|------------------|-------------------|--------------|--------|-------------|-------|
|                  |                   |              |        | Bez DPH     | S DPH |
| 60               | 002556            | 100          | 20 800 | 0,20        | 0,24  |
| 100              | 002563            | 100          | 15 600 | 0,32        | 0,38  |
| 150              | 002570            | 50           | 10 400 | 0,55        | 0,66  |

## MONTÁŽNA PLATŇA M10

P-POB-ZT MP



| Menovitá veľkosť | EAN číslo výrobku | Balenie v ks |       | Cena [€/ks] |       |
|------------------|-------------------|--------------|-------|-------------|-------|
|                  |                   |              |       | Bez DPH     | S DPH |
| 80 x 30          | 002518            | 25           | 5 200 | 1,16        | 1,39  |

## GUMOVÁ FAREBNÁ KRYTKA HROTU OBJÍMKY

P-POB-HT AKG



| Menovitá veľkosť | EAN číslo výrobku | Balenie v ks |        | Cena [€/ks] |       |
|------------------|-------------------|--------------|--------|-------------|-------|
|                  |                   |              |        | Bez DPH     | S DPH |
| 29 x 13          | 002280            | 50           | 20 000 | 0,24        | 0,29  |
| 29 x 13          | 002211            | 50           | 20 000 | 0,24        | 0,29  |
| 29 x 13          | 002235            | 50           | 20 000 | 0,24        | 0,29  |
| 29 x 13          | 002266            | 50           | 20 000 | 0,24        | 0,29  |
| 29 x 13          | 002242            | 50           | 20 000 | 0,24        | 0,29  |
| 29 x 13          | 002228            | 50           | 20 000 | 0,24        | 0,29  |
| 29 x 13          | 002273            | 50           | 20 000 | 0,24        | 0,29  |
| 29 x 13          | 002259            | 50           | 20 000 | 0,24        | 0,29  |
| 29 x 13          | 002297            | 50           | 20 000 | 0,24        | 0,29  |

## ZACHYTÁVAČ VODY HRANATÝ

PH-PZVH

| Menovitá veľkosť  | 80/80 MAFA |              | 100/100 MAFA |              | 120/120 MAFA |              |
|---|------------|--------------|--------------|--------------|--------------|--------------|
|   | Bez DPH    | S DPH        | Bez DPH      | S DPH        | Bez DPH      | S DPH        |
| <b>TM</b> 1<br>Testa di Moro<br>RAL 8028  | 30,00      | <b>36,00</b> | 32,00        | <b>38,40</b> | 37,00        | <b>44,40</b> |
|   | 022547     |              | 022554       |              | 022561       |              |
| <b>AN</b> 2<br>Antracit<br>RAL 7016   | 30,00      | <b>36,00</b> | 32,00        | <b>38,40</b> | 37,00        | <b>44,40</b> |
|   | 022240     |              | 022257       |              | 022264 *     |              |
| <b>IC</b> 3<br>Intenzívna čierna<br>RAL 9005  | 30,00      | <b>36,00</b> | 32,00        | <b>38,40</b> | 37,00        | <b>44,40</b> |
|   | 022301     |              | 022318       |              | 022325 *     |              |
| <b>OC</b> 4<br>Oceľovo červená<br>RAL 3009  | 30,00      | <b>36,00</b> | 32,00        | <b>38,40</b> | 37,00        | <b>44,40</b> |
|   | 022455 *   |              | 022462 *     |              | 022479 *     |              |
| <b>MH</b> 5<br>Medeno hnedá<br>RAL 8004   | 30,00      | <b>36,00</b> | 32,00        | <b>38,40</b> | 37,00        | <b>44,40</b> |
|   | 022332 *   |              | 022349 *     |              | 022356 *     |              |
| <b>SB</b> 6<br>Šedo biela<br>RAL 9002   | 30,00      | <b>36,00</b> | 32,00        | <b>38,40</b> | 37,00        | <b>44,40</b> |
|   | 022516 *   |              | 022523 *     |              | 022530 *     |              |
| <b>BH</b> 7<br>Bielo hliníková<br>RAL 9006  | 30,00      | <b>36,00</b> | 32,00        | <b>38,40</b> | 37,00        | <b>44,40</b> |
|   | 022271 *   |              | 022288 *     |              | 022295 *     |              |
| <b>PS</b> 8<br>Prachovo šedá<br>RAL 7037  | 30,00      | <b>36,00</b> | 32,00        | <b>38,40</b> | 37,00        | <b>44,40</b> |
|   | 022486 *   |              | 022493 *     |              | 022509 *     |              |
| <b>MM</b> 9<br>Metalická medená<br>RAL extra  | 30,00      | <b>36,00</b> | 32,00        | <b>38,40</b> | 37,00        | <b>44,40</b> |
|   | 022363 *   |              | 022370 *     |              | 022387 *     |              |
| <b>BHT – P.20</b> 10<br>Bielo hliníková tmavá<br>RAL 9007   |            |              |              |              |              |              |
| <b>MZ</b> 11<br>Machovo zelená<br>RAL 6005  | 30,00      | <b>36,00</b> | 32,00        | <b>38,40</b> | 37,00        | <b>44,40</b> |
|   | 022424 *   |              | 022431 *     |              | 022448 *     |              |
| <b>MOT</b> 12<br>Tmavo modrá<br>RAL 5010  | 30,00      | <b>36,00</b> | 32,00        | <b>38,40</b> | 37,00        | <b>44,40</b> |
|   | 022394 *   |              | 022400 *     |              | 022417 *     |              |
| <b>TZ</b> 13<br>Trávovo zelená<br>RAL 6011  | 30,00      | <b>36,00</b> | 32,00        | <b>38,40</b> | 37,00        | <b>44,40</b> |
|   | 022578 *   |              | 022585 *     |              | 022592 *     |              |
| <b>Balenie v ks</b>  | <b>3</b>   |              | <b>3</b>     |              | <b>2</b>     |              |
| <b>Balenie v ks</b>  | <b>90</b>  |              | <b>90</b>    |              | <b>60</b>    |              |

\* Výroba na objednávku  
MAFA – Manufaktúra (ručná výroba)





## OCHRANNÁ RÚRA S REVÍZNYM OTVOROM

P-POZR



| Menovitá veľkosť  | 80        |              | 100       |              | 100       |               |
|---|-----------|--------------|-----------|--------------|-----------|---------------|
|   | 1,0       |              | 1,0       |              | 1,5       |               |
| Dĺžka v m   | 1,0       |              | 1,0       |              | 1,5       |               |
| Cena v €/m  | Bez DPH   | S DPH        | Bez DPH   | S DPH        | Bez DPH   | S DPH         |
| <b>TM</b> 1<br>Testa di Moro<br>RAL 8028                  | 64,00     | <b>76,80</b> | 49,00     | <b>58,80</b> | 97,00     | <b>116,40</b> |
|   | 010254 *  |              | 010261    |              | 010278    |               |
| <b>AN</b> 2<br>Antracit<br>RAL 7016                       | 64,00     | <b>76,80</b> | 49,00     | <b>58,80</b> | 97,00     | <b>116,40</b> |
|   | 009760 *  |              | 009777    |              | 009784 *  |               |
| <b>IC</b> 3<br>Intenzívna čierna<br>RAL 9005              | 64,00     | <b>76,80</b> | 49,00     | <b>58,80</b> | 97,00     | <b>116,40</b> |
|   | 009869 *  |              | 009876    |              | 009883 *  |               |
| <b>OC</b> 4<br>Oceľovo červená<br>RAL 3009                | 64,00     | <b>76,80</b> | 49,00     | <b>58,80</b> | 97,00     | <b>116,40</b> |
|   | 010117 *  |              | 010124 *  |              | 010131 *  |               |
| <b>MH</b> 5<br>Medeno hnedá<br>RAL 8004                   | 64,00     | <b>76,80</b> | 49,00     | <b>58,80</b> | 97,00     | <b>116,40</b> |
|   | 009913 *  |              | 009920 *  |              | 009937 *  |               |
| <b>SB</b> 6<br>Šedo biela<br>RAL 9002                     | 64,00     | <b>76,80</b> | 49,00     | <b>58,80</b> | 97,00     | <b>116,40</b> |
|   | 010209 *  |              | 010247 *  |              | 010216 *  |               |
| <b>BH</b> 7<br>Bielo hliníková<br>RAL 9006                | 64,00     | <b>76,80</b> | 49,00     | <b>58,80</b> | 97,00     | <b>116,40</b> |
|   | 009814 *  |              | 009821 *  |              | 009838 *  |               |
| <b>PS</b> 8<br>Prachovo šedá<br>RAL 7037                  | 64,00     | <b>76,80</b> | 49,00     | <b>58,80</b> | 97,00     | <b>116,40</b> |
|   | 010162 *  |              | 010179 *  |              | 010186 *  |               |
| <b>MM</b> 9<br>Metalická medená<br>RAL extra              | 64,00     | <b>76,80</b> | 49,00     | <b>58,80</b> | 97,00     | <b>116,40</b> |
|   | 009968 *  |              | 009975 *  |              | 009982 *  |               |
| <b>BHT – P.20</b> 10<br>Bielo hliníková tmavá<br>RAL 9007 | 64,00     | <b>76,80</b> | 49,00     | <b>58,80</b> |           |               |
|   | 096494 *  |              | 096500 *  |              |           |               |
| <b>MZ</b> 11<br>Machovo zelená<br>RAL 6005                | 64,00     | <b>76,80</b> | 49,00     | <b>58,80</b> | 97,00     | <b>116,40</b> |
|   | 010063 *  |              | 010070 *  |              | 010087 *  |               |
| <b>MOT</b> 12<br>Tmavo modrá<br>RAL 5010                  | 64,00     | <b>76,80</b> | 49,00     | <b>58,80</b> | 97,00     | <b>116,40</b> |
|   | 010018 *  |              | 010025 *  |              | 010032 *  |               |
| <b>TZ</b> 13<br>Trávovo zelená<br>RAL 6011                | 64,00     | <b>76,80</b> | 49,00     | <b>58,80</b> | 97,00     | <b>116,40</b> |
|   | 010308 *  |              | 010315 *  |              | 010322 *  |               |
| <b>Balenie v ks</b>                                       | <b>1</b>  |              | <b>1</b>  |              | <b>1</b>  |               |
| <b>Balenie v ks</b>                                       | <b>70</b> |              | <b>60</b> |              | <b>60</b> |               |

\* Výroba na objednávku

## OCHRANNÁ RÚRA S REVÍZNYM OTVOROM

P-POZR

| Menovitá veľkosť  | 120      |               | 120      |               |
|---|----------|---------------|----------|---------------|
| Dĺžka v m   | 1,0      |               | 1,5      |               |
| Cena v €/m  | Bez DPH  | S DPH         | Bez DPH  | S DPH         |
| <b>TM</b><br>Testa di Moro<br>RAL 8028  | 115,00   | <b>138,00</b> | 165,00   | <b>198,00</b> |
|   | 010285   |               | 010292 * |               |
| <b>AN</b><br>Antracit<br>RAL 7016   | 115,00   | <b>138,00</b> | 165,00   | <b>198,00</b> |
|   | 009791 * |               | 009807 * |               |
| <b>IC</b><br>Intenzívna čierna<br>RAL 9005  | 115,00   | <b>138,00</b> | 165,00   | <b>198,00</b> |
|   | 009890 * |               | 009906 * |               |
| <b>OC</b><br>Oceľovo červená<br>RAL 3009  | 115,00   | <b>138,00</b> | 165,00   | <b>198,00</b> |
|   | 010148 * |               | 010155 * |               |
| <b>MH</b><br>Medeno hnedá<br>RAL 8004   | 115,00   | <b>138,00</b> | 165,00   | <b>198,00</b> |
|   | 009944 * |               | 009951 * |               |
| <b>SB</b><br>Šedo biela<br>RAL 9002   | 115,00   | <b>138,00</b> | 165,00   | <b>198,00</b> |
|   | 010223 * |               | 010230 * |               |
| <b>BH</b><br>Bielo hliníková<br>RAL 9006  | 115,00   | <b>138,00</b> | 165,00   | <b>198,00</b> |
|   | 009845 * |               | 009852 * |               |
| <b>PS</b><br>Prachovo šedá<br>RAL 7037  | 115,00   | <b>138,00</b> | 165,00   | <b>198,00</b> |
|   | 010193 * |               | 009753 * |               |
| <b>MM</b><br>Metalická medená<br>RAL extra  | 115,00   | <b>138,00</b> | 165,00   | <b>198,00</b> |
|   | 009999 * |               | 010001 * |               |
| <b>BHT – P.20</b><br>Bielo hliníková tmavá<br>RAL 9007  | 115,00   | <b>138,00</b> |          |               |
|   | 096517 * |               |          |               |
| <b>MZ</b><br>Machovo zelená<br>RAL 6005   | 115,00   | <b>138,00</b> | 165,00   | <b>198,00</b> |
|   | 010094 * |               | 010100 * |               |
| <b>MOT</b><br>Tmavo modrá<br>RAL 5010   | 115,00   | <b>138,00</b> | 165,00   | <b>198,00</b> |
|   | 010049 * |               | 010056 * |               |
| <b>TZ</b><br>Trávovo zelená<br>RAL 6011   | 115,00   | <b>138,00</b> | 165,00   | <b>198,00</b> |
|   | 010339 * |               | 010346 * |               |
| <b>Balenie v ks</b>  | 1        |               | 1        |               |
| <b>Balenie v ks</b>  | 40       |               | 40       |               |

\* Výroba na objednávku



POZINK  
POLYESTER

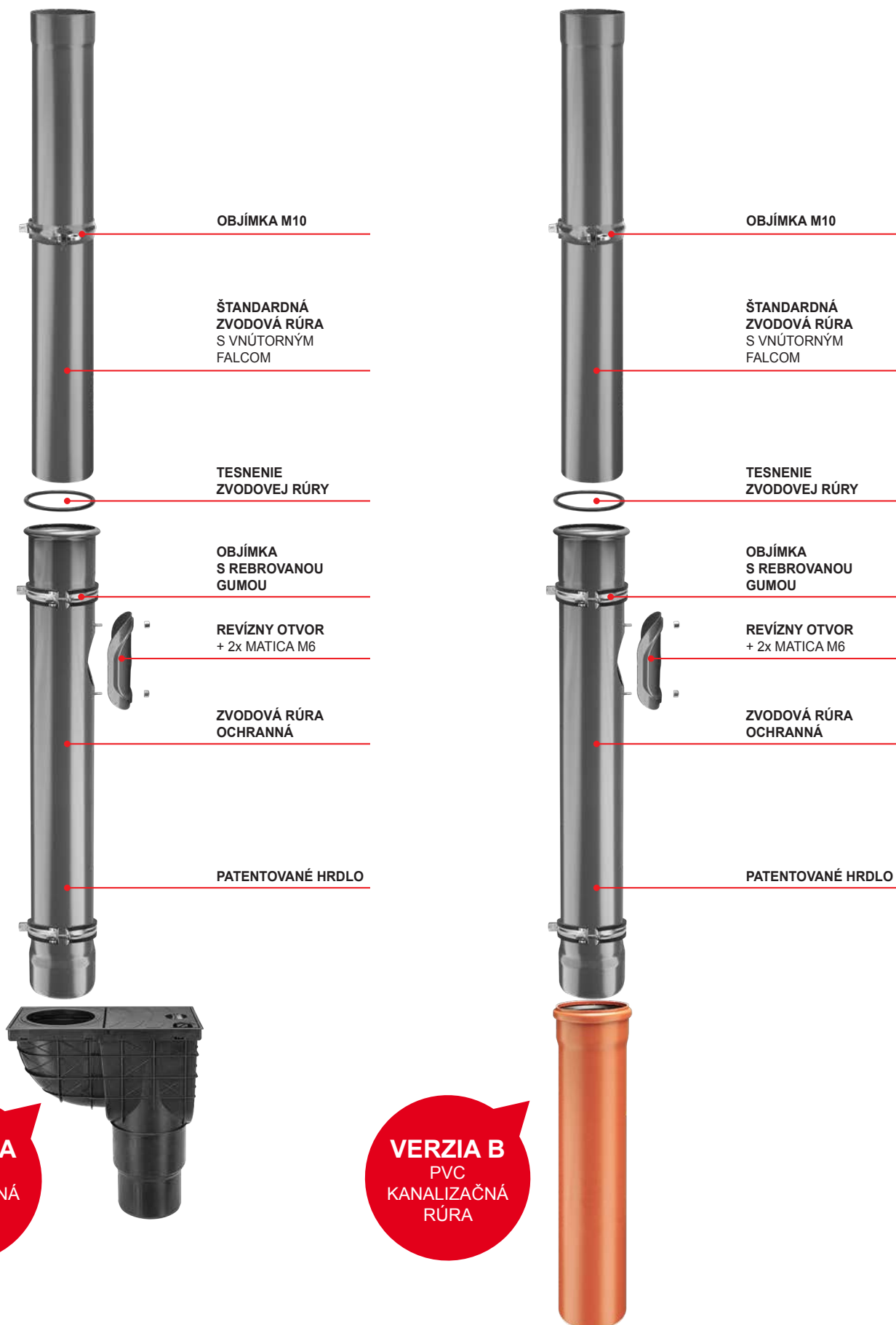

**VERZIA A**  
PVC  
KANALIZAČNÁ  
VPUŠŤ

**VERZIA B**  
PVC  
KANALIZAČNÁ  
RÚRA

## OBJÍMKA S REBROVOU GUMOU M10

P-POB-OZR



| Menovitá<br>vel'kost' | EAN<br>číslo výrobku | Balenie v ks |       | Cena [€/ks] |             |
|-----------------------|----------------------|--------------|-------|-------------|-------------|
|                       |                      |              |       | Bez DPH     | S DPH       |
| 80                    | 002525               | 25           | 1 250 | 1,58        | <b>1,90</b> |
| 100                   | 002532               | 25           | 1 250 | 2,00        | <b>2,40</b> |
| 120                   | 002549               | 20           | 1 000 | 2,26        | <b>2,71</b> |

## KANALIZAČNÁ VPUŠŤ PRIAMA

SD-KV AGV4



| Menovitá<br>vel'kost' | EAN<br>číslo výrobku | Balenie v ks |    | Cena [€/ks] |              |
|-----------------------|----------------------|--------------|----|-------------|--------------|
|                       |                      |              |    | Bez DPH     | S DPH        |
| 125/110               | 009623               | 1            | 60 | 10,50       | <b>12,60</b> |
| 125/110               | 009630               | 1            | 60 | 10,50       | <b>12,60</b> |

## KANALIZAČNÁ VPUŠŤ BOČNÁ

SD-KV AGV3



| Menovitá<br>vel'kost' | EAN<br>číslo výrobku | Balenie v ks |     | Cena [€/ks] |              |
|-----------------------|----------------------|--------------|-----|-------------|--------------|
|                       |                      |              |     | Bez DPH     | S DPH        |
| 110                   | 009616               | 1            | 120 | 16,00       | <b>19,20</b> |

## UNIVERZÁLNA VLOŽKA ZVODU VPUSTE

SD-KV AGV911

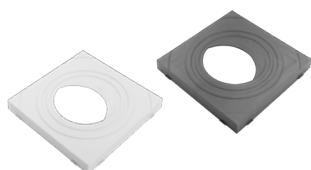

| Menovitá<br>vel'kost' | EAN<br>číslo výrobku | Balenie v ks |       | Cena [€/ks] |             |
|-----------------------|----------------------|--------------|-------|-------------|-------------|
|                       |                      |              |       | Bez DPH     | S DPH       |
| 80, 100, 120          | 009647               | 5            | 1 200 | 2,55        | <b>3,06</b> |
| 80, 100, 120          | 009654               | 5            | 1 200 | 2,55        | <b>3,06</b> |

